

# COMBO30

SURFACE, SUSPENDED PROFILES / PROFILE NAWIERZCHNIOWE, ZWIESZANE  
LIGHTING PROFILES / PROFILE OŚWIETLENIOWE

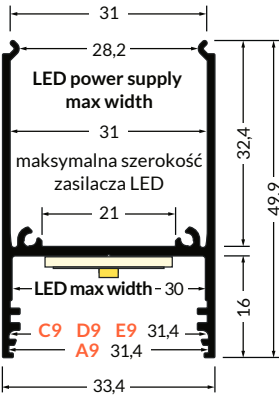

## COMBO30-01



## COMBO30-02

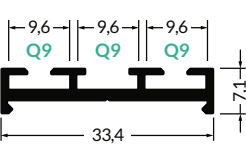

## COMBO30-03

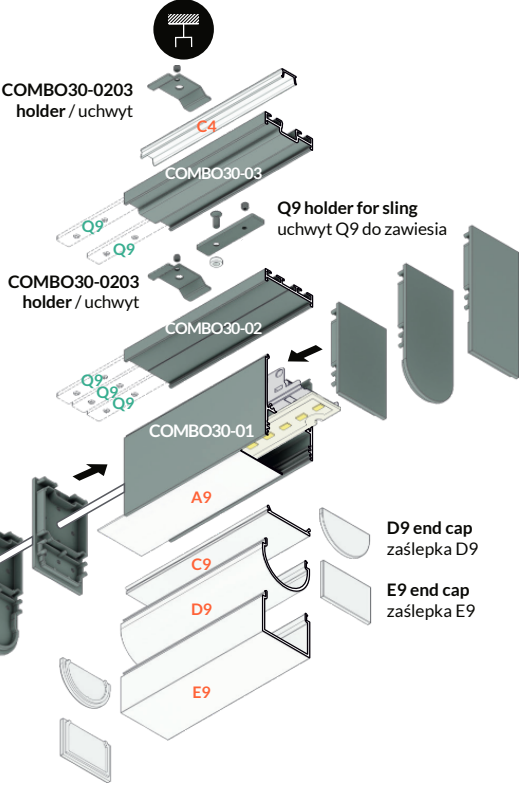
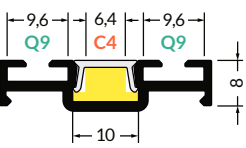

## A COMBO30-01 + COMBO30-02

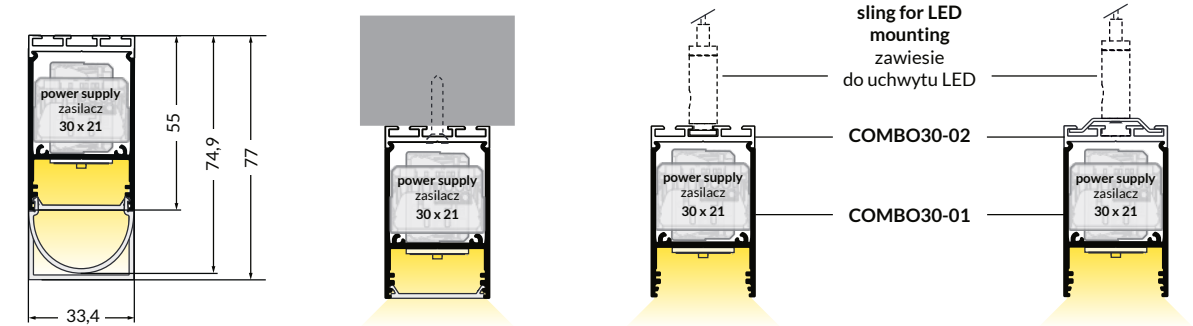

## B COMBO30-01 + COMBO30-03

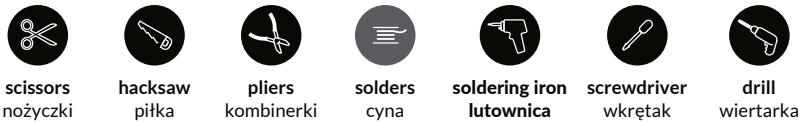
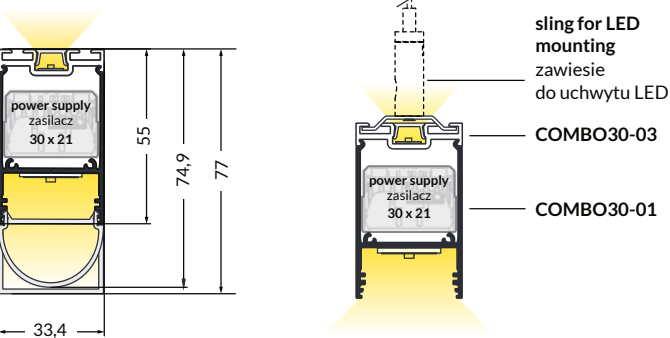

Mounting must be performed by an appropriately qualified person.  
Mounting must be performed with the 230 V power supply disconnected  
Montaż powinna wykonać osoba posiadająca odpowiednie uprawnienia.  
Montaż oprawy wykonywać przy odłączonym zasilaniu siecowym 230 V

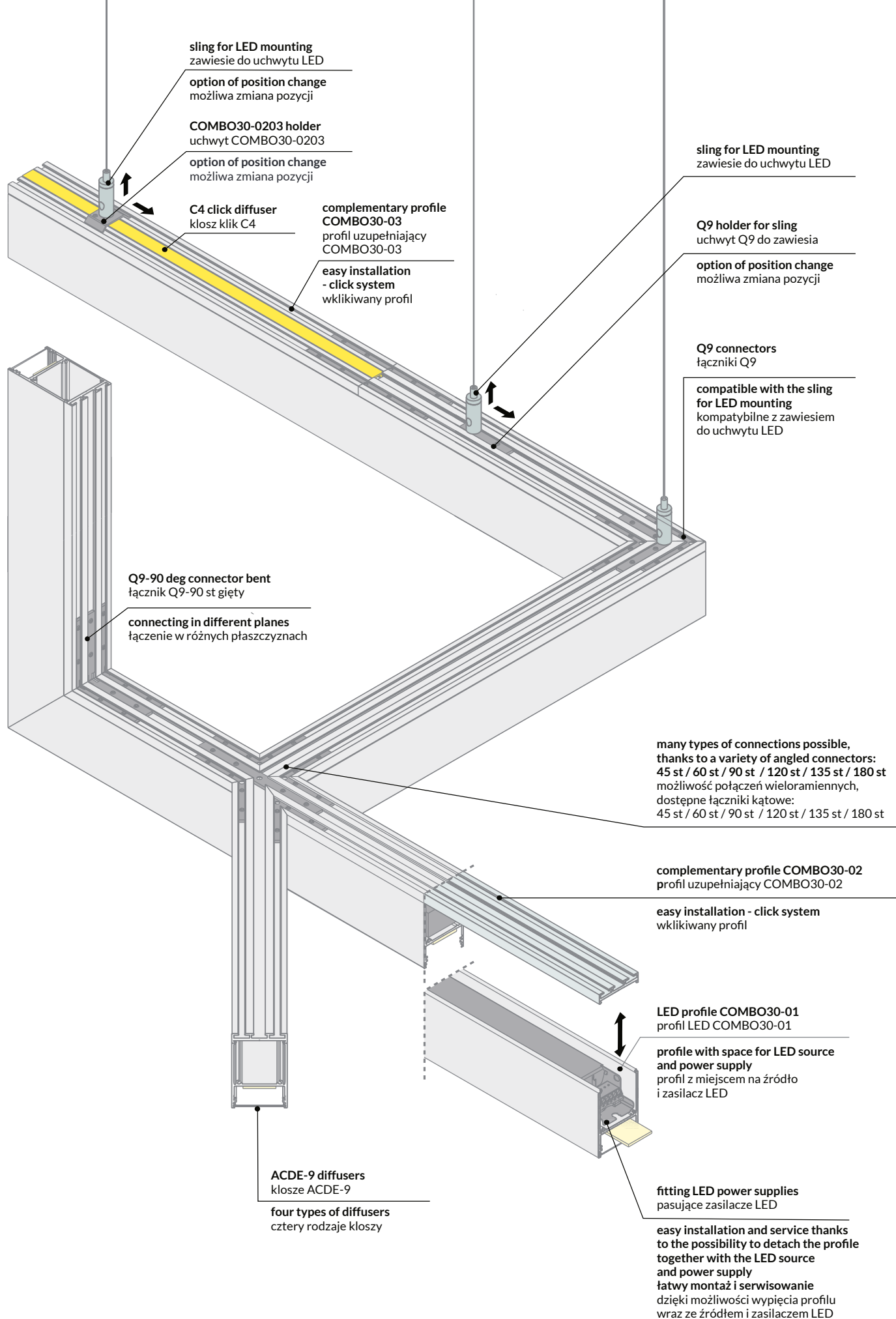

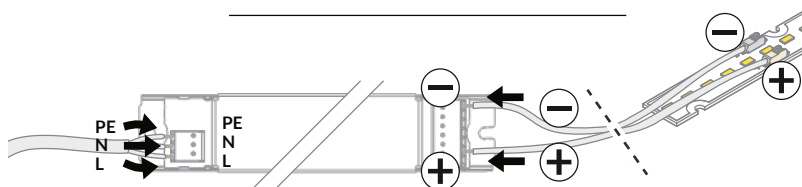
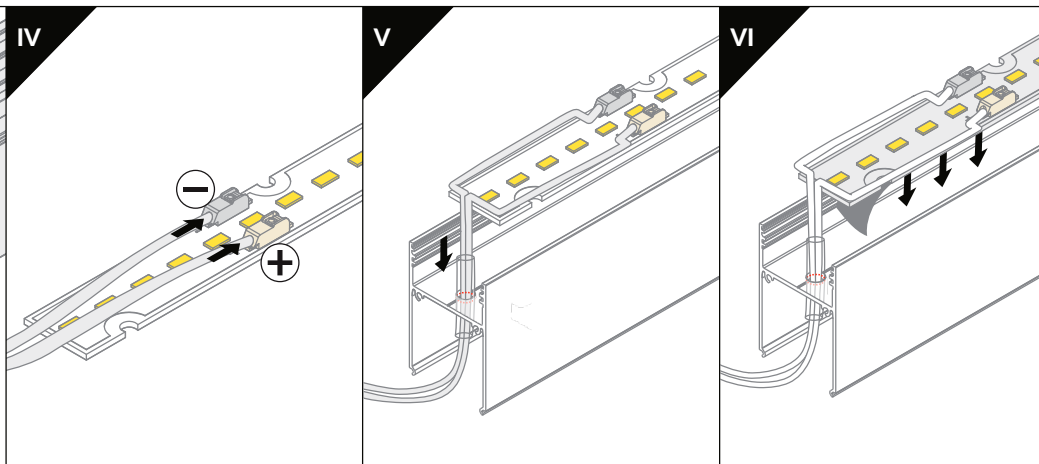
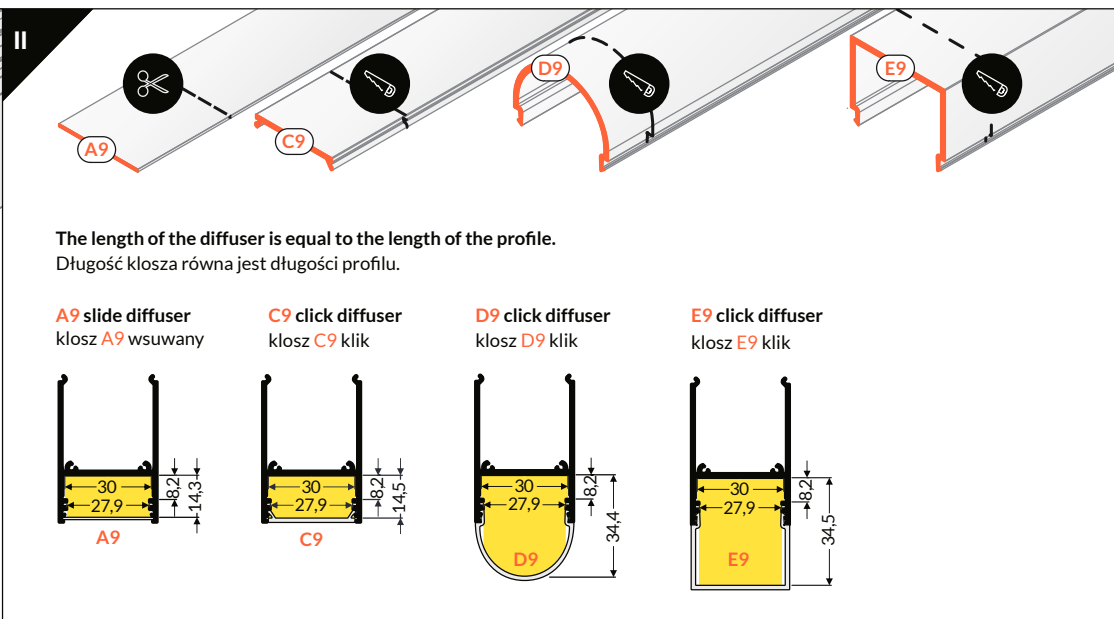

VIII

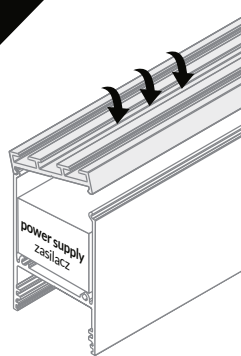

IX

A9 slide diffuser  
klosz A9 wsuwany

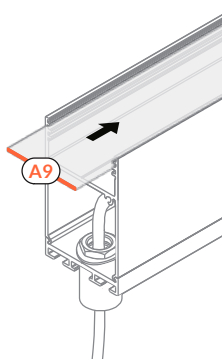

C9 click diffuser  
klosz C9 klik

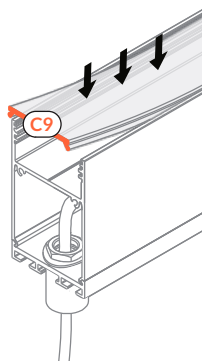

D9 click diffuser  
klosz D9 klik

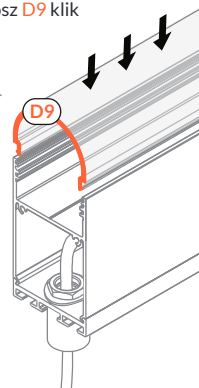

E9 click diffuser  
klosz E9 klik

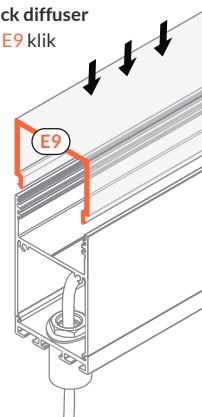

X

## MOUNTING A SLING TO THE LED MOUNTING TO THE LUMINAIRE / MONTAŻ ZAWIESIA DO UCHWYTU LED DO OPRAWY

COMBO30-0203 holder  
uchwyt COMBO30-0203

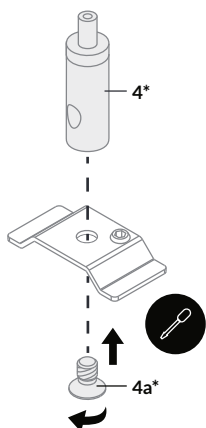

Q9 holder for a sling  
uchwyt Q9 do zawiesia

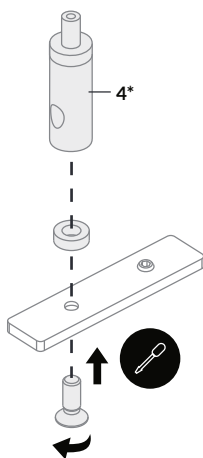

Q9-180 deg connector  
łącznik Q9-180 st  
screw for Q9 connector  
wkret do łącznika Q9

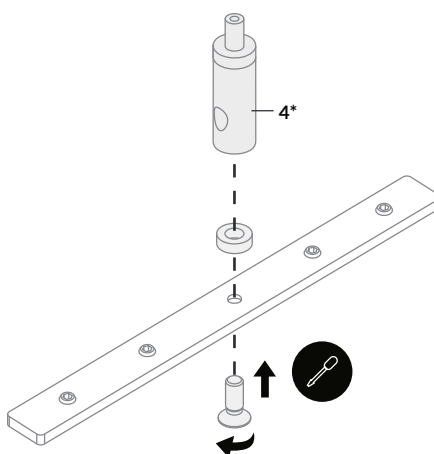

\* MORE DETAILS:

manual sling for mounting

\* WIĘCEJ SZCZEGÓŁÓW:

instrukcja zawiesia do uchwytu LED



In case of mounting even long lighting fixtures, a set (two slings) is enough.

However, it is recommended to use an additional sling to increase stabilization.

W przypadku montowania nawet długich opraw oświetleniowych wystarczy komplet, czyli 2 sztuki zawiesi. Zaleca się jednak użycia dodatkowego zawiesia w celu zwiększenia stabilizacji

XI

COMBO30-0203 holder  
uchwyt COMBO30-0203

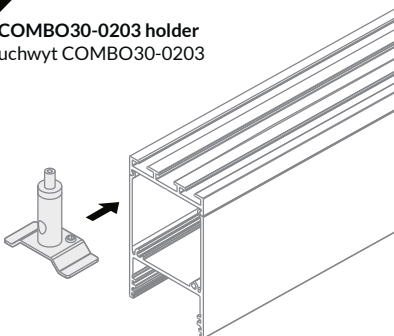

Q9 holder for a sling  
uchwyt Q9 do zawiesia

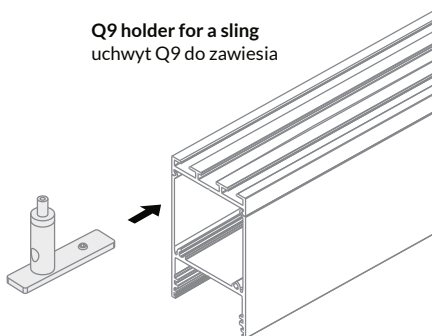

Q9-180 deg connector  
łącznik Q9-180 st  
screw for Q9 connector  
wkret do łącznika Q9

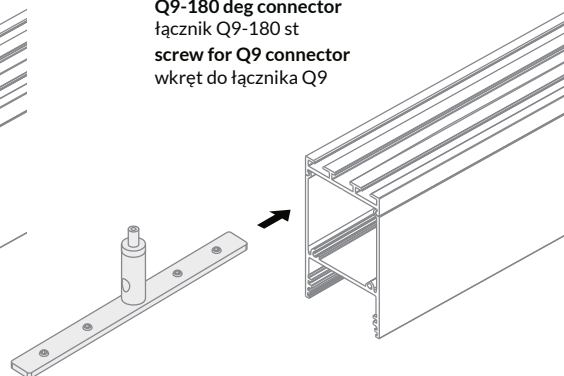

XII

A9 slide diffuser  
klosz A9 wsuwany

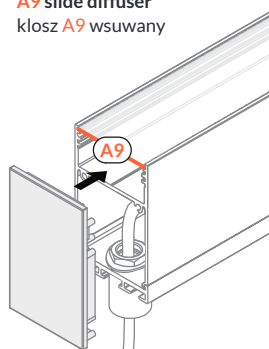

C9 click diffuser  
klosz C9 klik

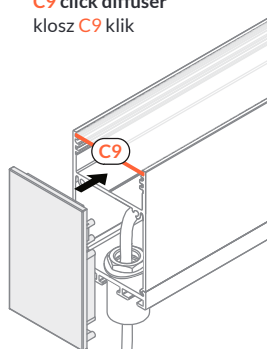

D9 click diffuser  
klosz D9 klik

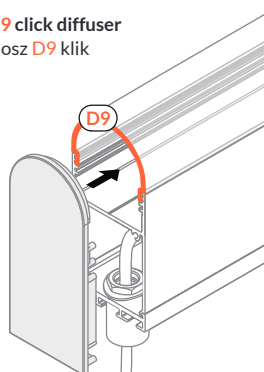

E9 click diffuser  
klosz E9 klik

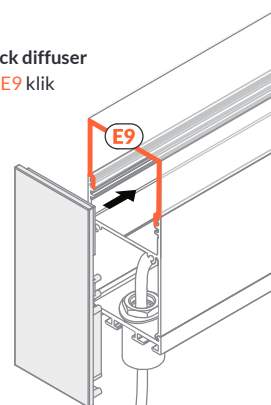

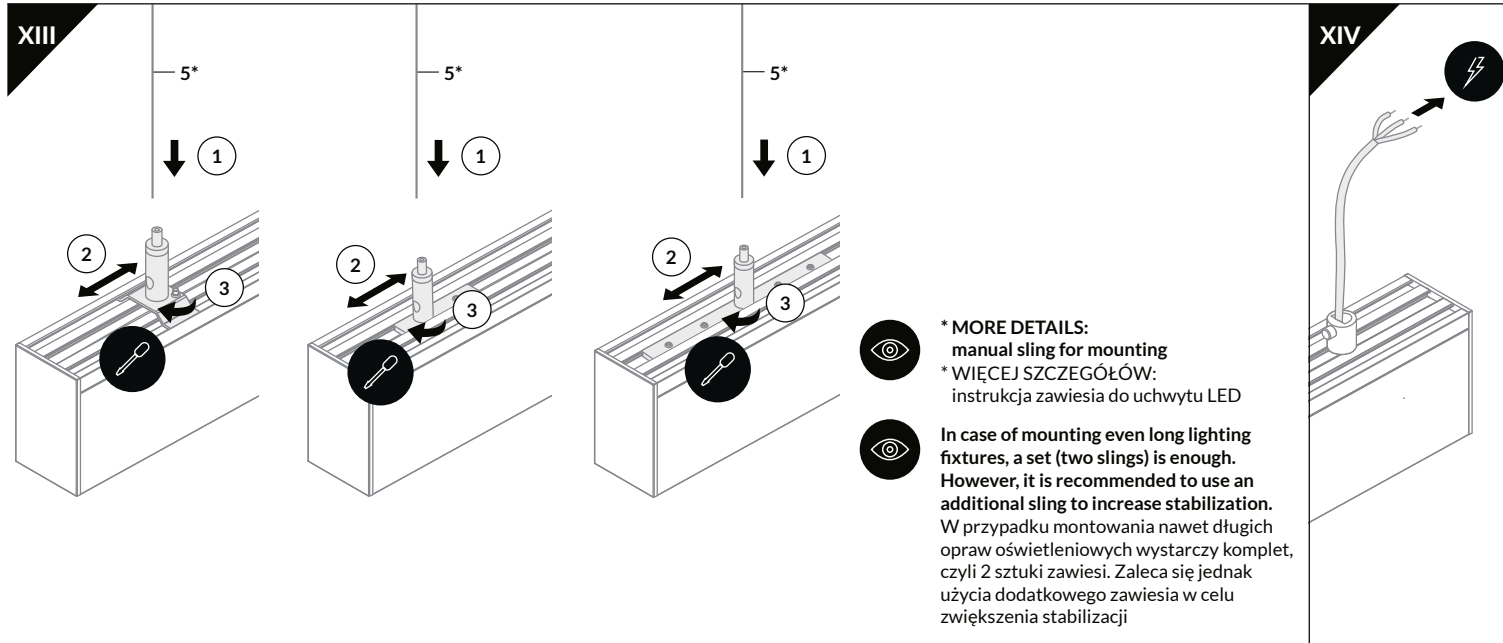

## B COMBO30-01 + COMBO30-03

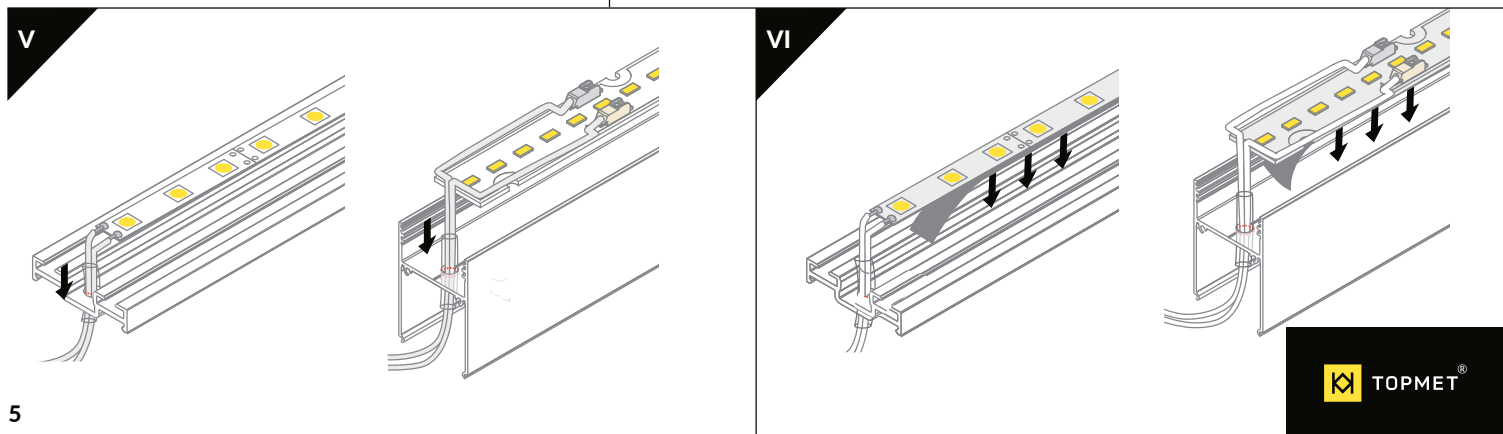
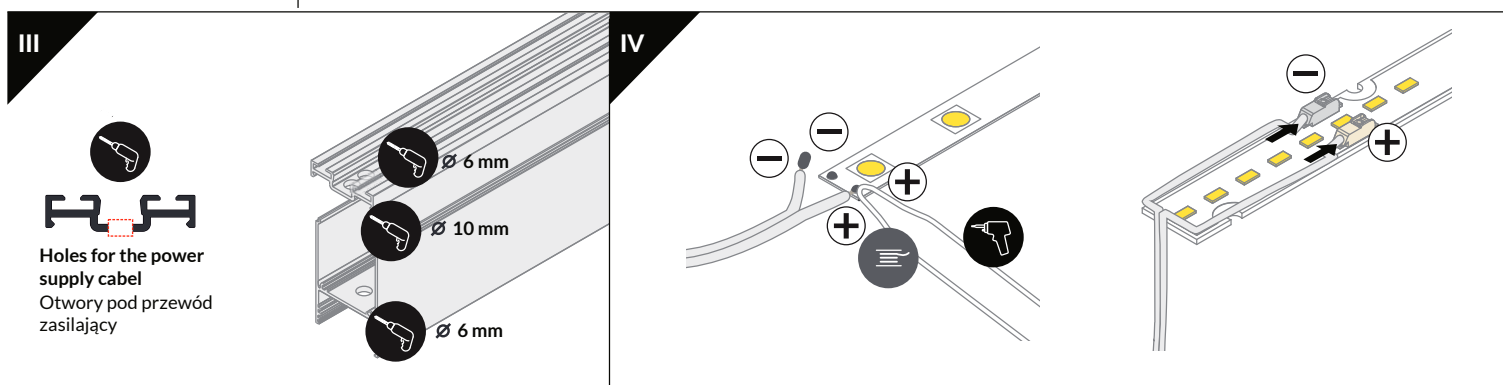
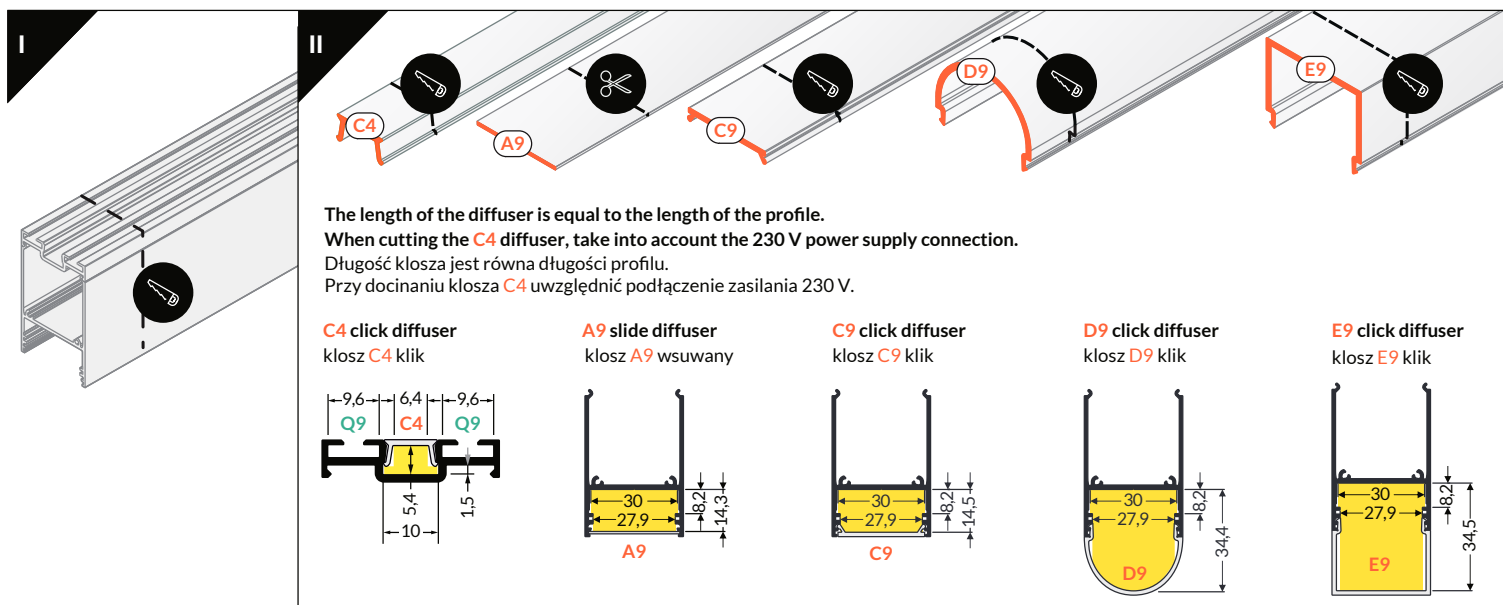



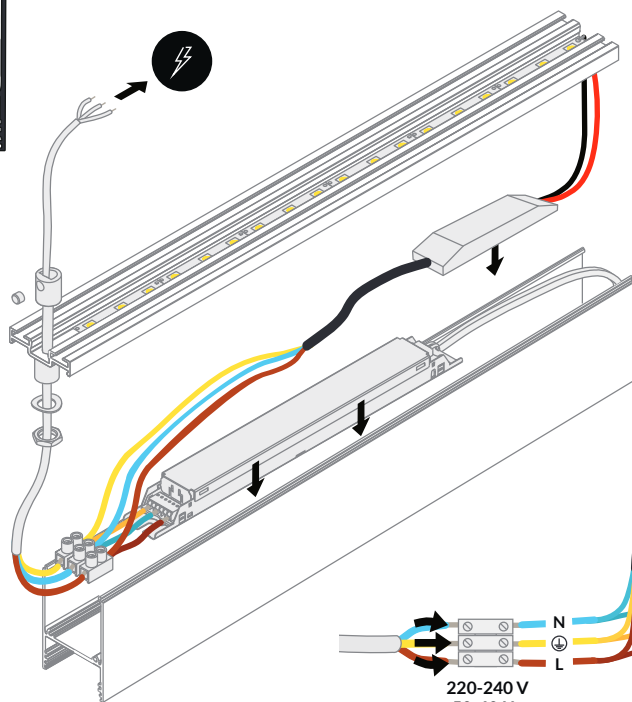

### ELECTRICAL CONNECTION LAYOUT SCHEMAT POŁĄCZEŃ ELEKTRYCZNYCH

power supply for LED strip  
zasilacz do taśmy LED

100-240 V AC  
50-60 Hz

12-24 V

power supply for LED module  
zasilacz do modułu LED

220-240 V  
50-60 Hz

PE  
N  
L

PE  
N  
L

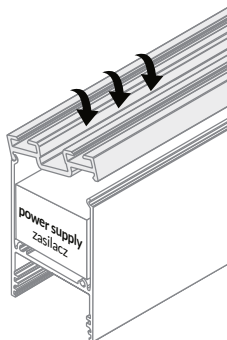

C4 click diffuser  
klosz C4 klik

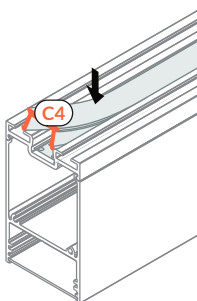

A9 slide diffuser  
klosz A9 wsuwany

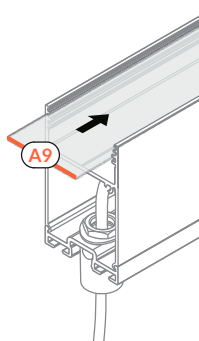

C9 click diffuser  
klosz C9 klik

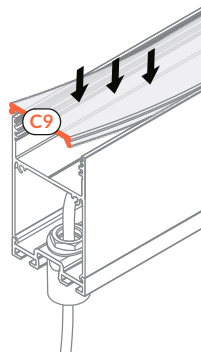

D9 click diffuser  
klosz D9 klik

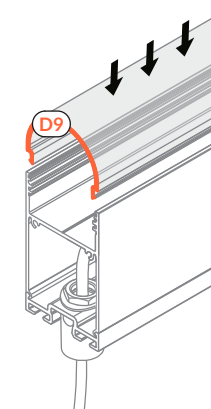

E9 click diffuser  
klosz E9 klik

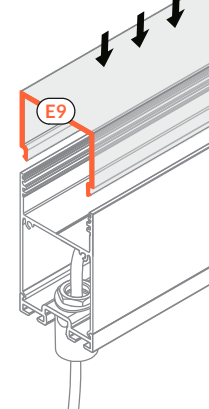

### MOUNTING A SLING TO THE LED MOUNTING TO THE LUMINAIRE / MONTAŻ ZAWIESIA DO UCHWYTU LED DO OPRAWY

COMBO30-0203 holder  
uchwyt COMBO30-0203

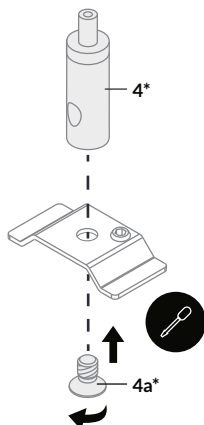

\* MORE DETAILS:  
manual sling for mounting  
\* WIĘCEJ SZCZEGÓŁÓW:  
instrukcja zawiesia do uchwytu LED



In case of mounting even long lighting fixtures, a set (two slings) is enough. However, it is recommended to use an additional sling to increase stabilization.  
W przypadku montowania nawet długich opraw oświetleniowych wystarczy komplet, czyli 2 sztuki zawiesi. Zaleca się jednak użycia dodatkowego zawiesia w celu zwiększenia stabilizacji

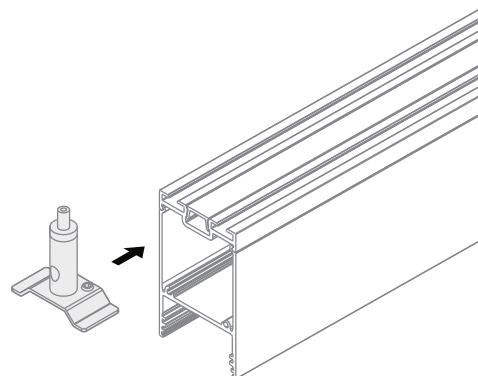

XII

A9 slide diffuser  
klosz A9 klik

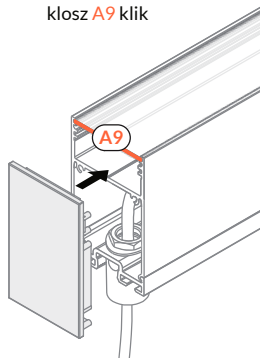

C9 click diffuser  
klosz C9 klik

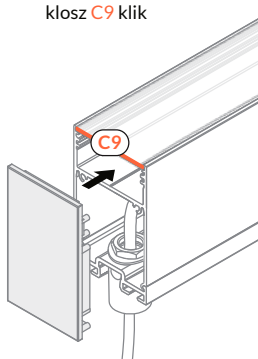

D9 click diffuser  
klosz D9 klik

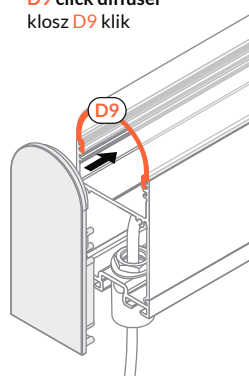

E9 click diffuser  
klosz E9 klik

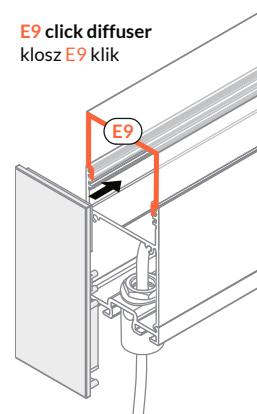

XII

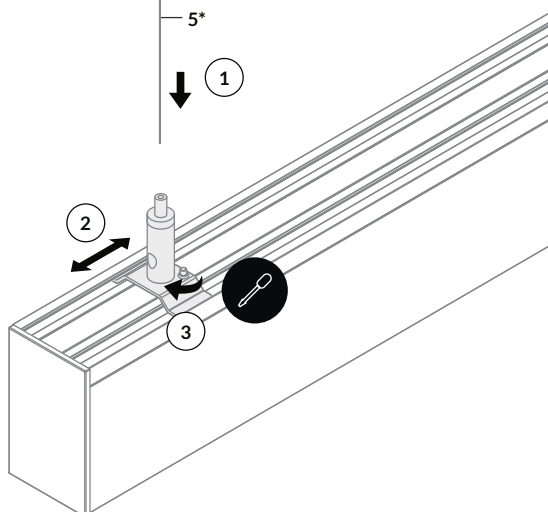

\* MORE DETAILS:  
manual sling for mounting  
\* WIĘCEJ SZCZEGÓŁÓW  
instrukcja zawiesia do uchwytu LED



In case of mounting even long lighting  
fixtures, a set (two slings) is enough.  
However, it is recommended to use an  
additional sling to increase stabilization.  
W przypadku montowania nawet długich  
opraw oświetleniowych wystarczy komplet,  
czyli 2 sztuki zawiesi. Zaleca się jednak  
użycia dodatkowego zawiesia w celu  
zwiększenia stabilizacji

XIII

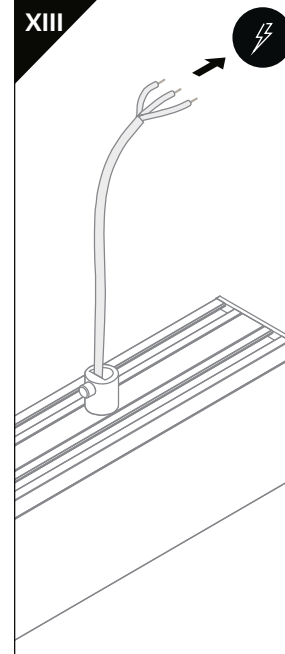

## MOUNTING Q9 CONNECTORS - ANGLED CONNECTIONS / MONTAŻ ŁĄCZNIKÓW Q9 - POŁĄCZENIA KĄTOWE

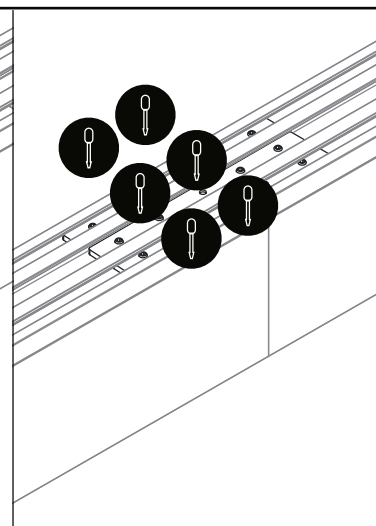
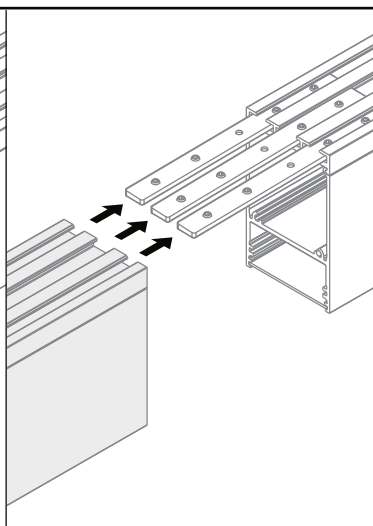
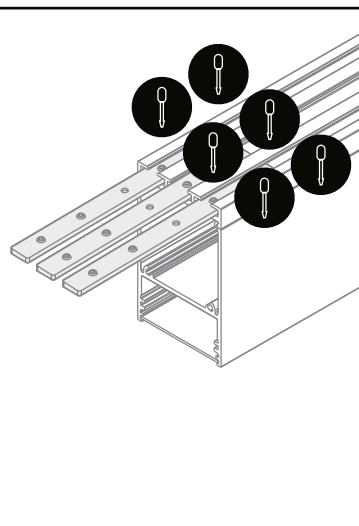
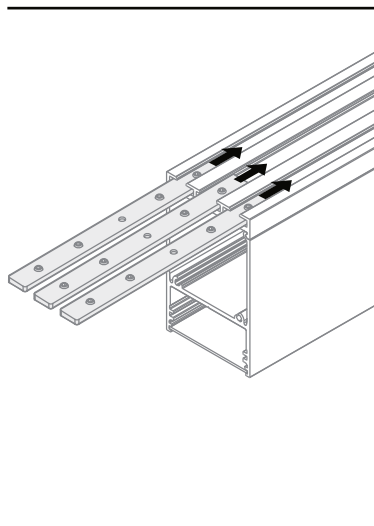

**A** COMBO30-01 + COMBO30-02

**B** COMBO30-01 + COMBO30-03

many types of connections possible, thanks to a variety of angled connectors:

45 deg / 60 deg / 90 deg / 120 deg / 135 deg / 180 deg

możliwość połączeń wieloramiennych, dostępne łączniki kątowe:

45 st / 60 st / 90 st / 120 st / 135 st / 180 st