

# FLOOR12 K/U

## RECESSED PROFILE PROFIL WPUSTOWY

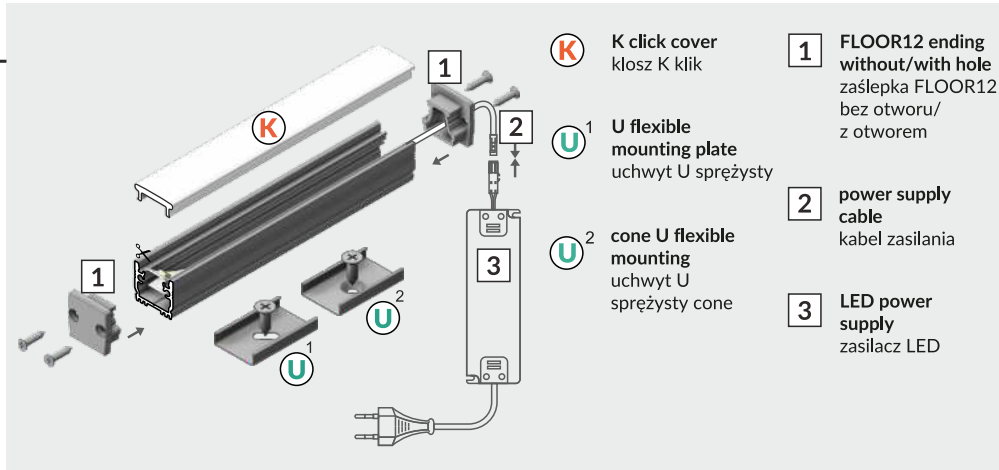

scissors  
nożyczki

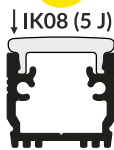
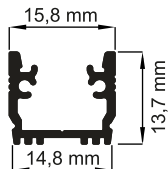

pliers  
kombinerki



hacksaw  
piła



silicone  
silikon



soldering iron  
lutownica



solder  
cyna



glue  
klej

I

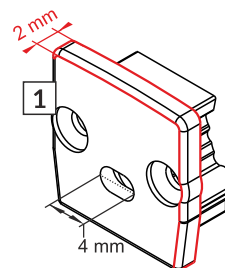
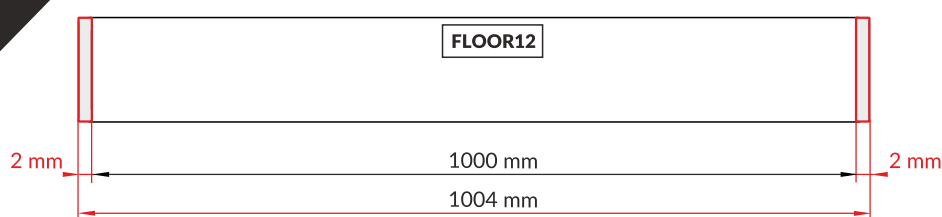

**Note! Ending thickness increases the length of the luminaire (+ 2 x 2 mm).**  
**Uwaga! Grubość zaślepki zwiększa długość oprawy (+ 2 x 2 mm).**

II

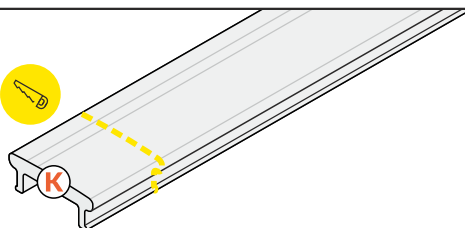

The length of the cover is equal to the length of the profile.  
Długość klosza równa jest długości profilu.

III

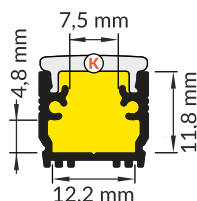

Dimensions of the space  
to install LED source.  
Wymiary przestrzeni  
do zamontowania źródła LED.

IV

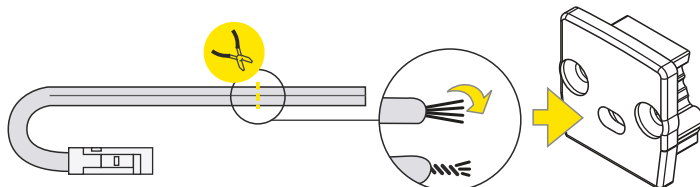

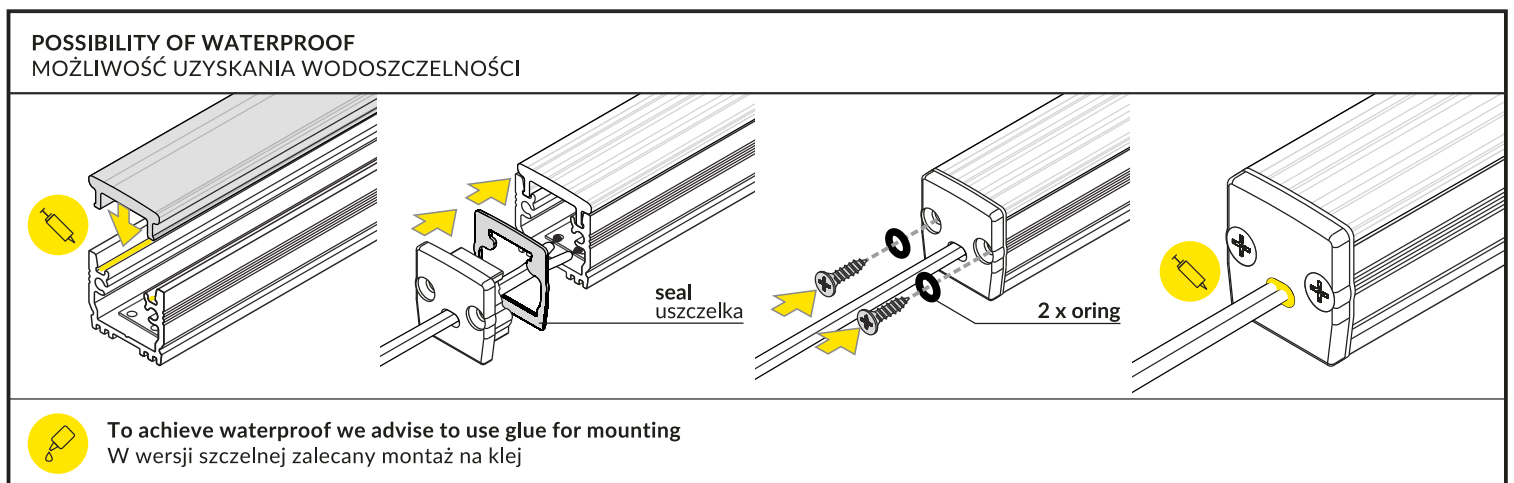
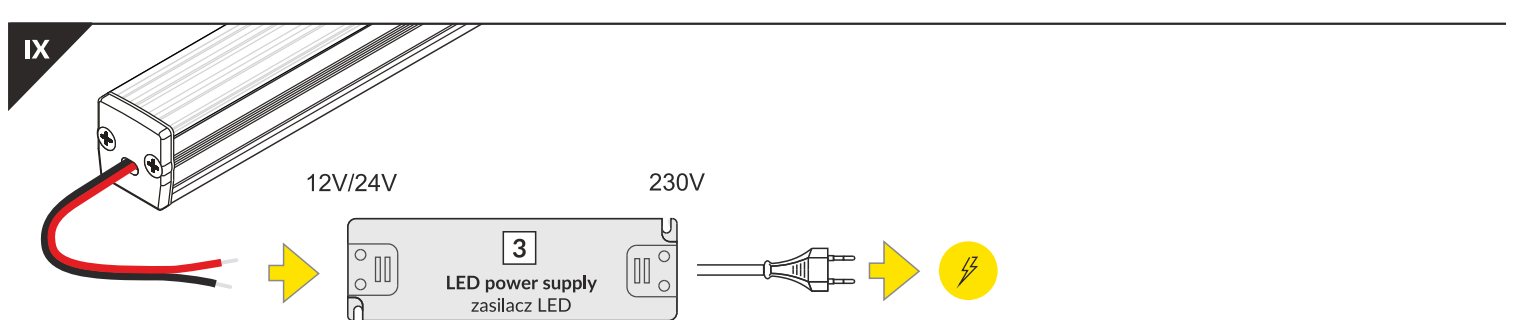
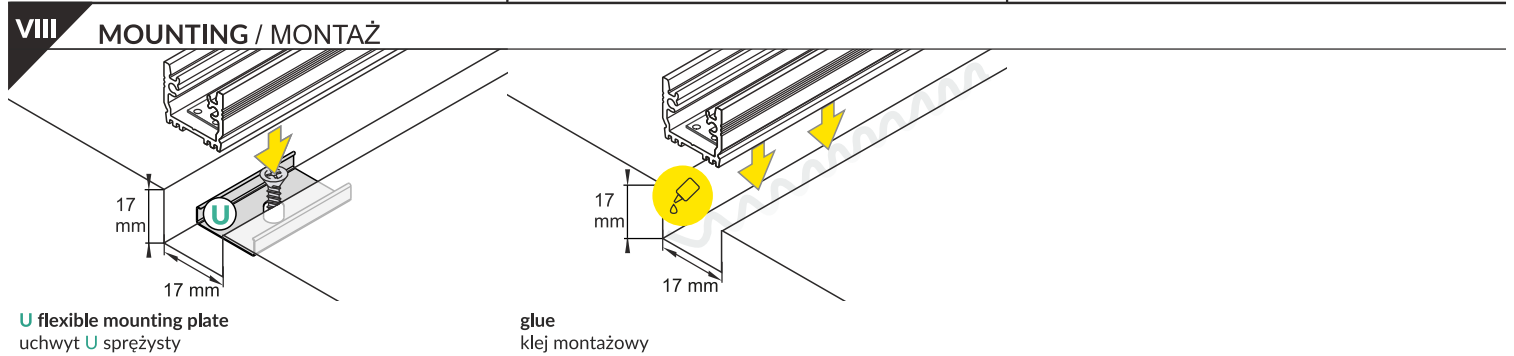
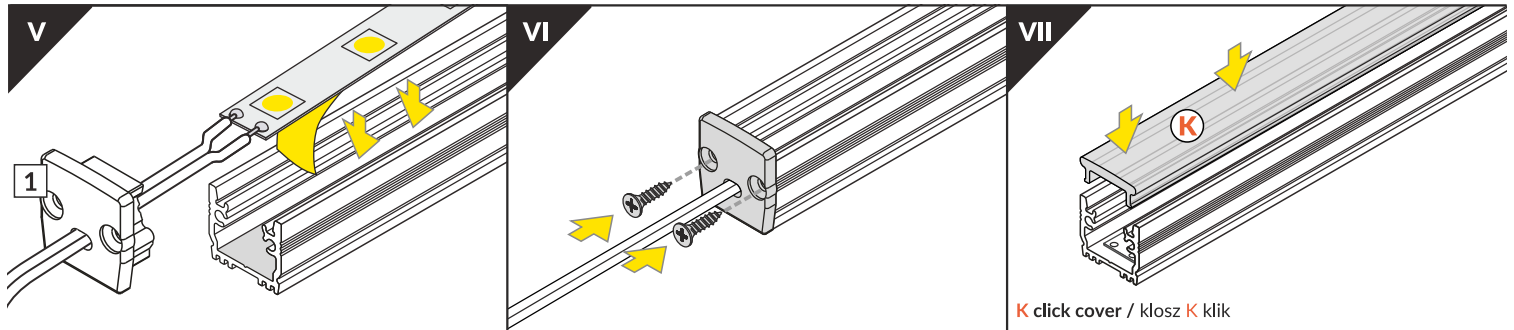

## ACCESSORIES / AKCESORIA

- power switches
- controller + remote
- movement sensors
- włączniki
- sterownik + pilot
- czujniki ruchu

Check the rest - TOPMET catalogue or [www.topmet.co.uk](http://www.topmet.co.uk)  
Zobacz więcej - katalog TOPMET lub [www.topmet.pl](http://www.topmet.pl)