

SMART-IN10 A/Z

RECESSED PROFILE PROFIL WPUSTOWY

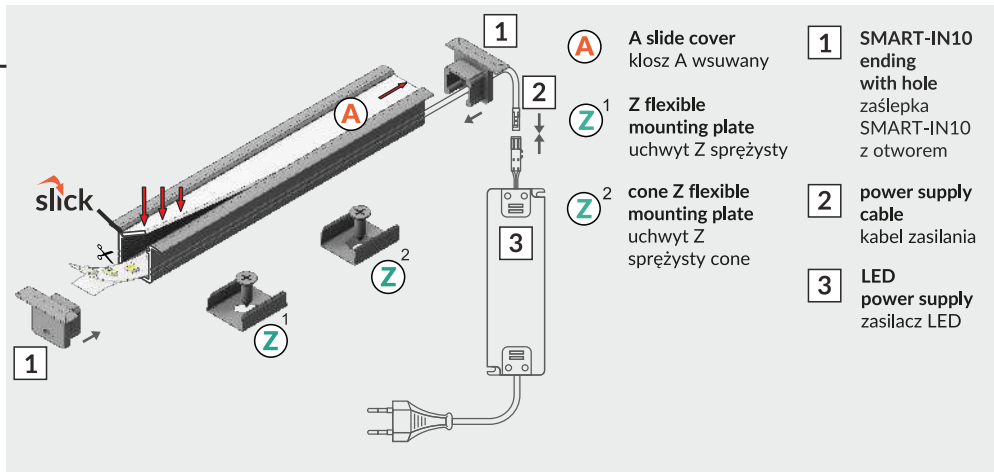

scissors
nożyczki

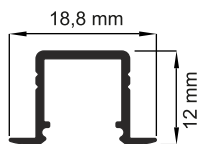
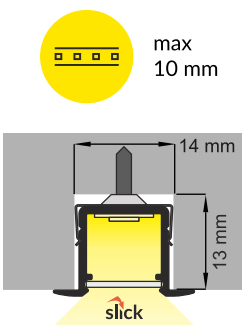

pliers
kombinerki



soldering iron
lutownica



solder
cyna



glue
klej

I

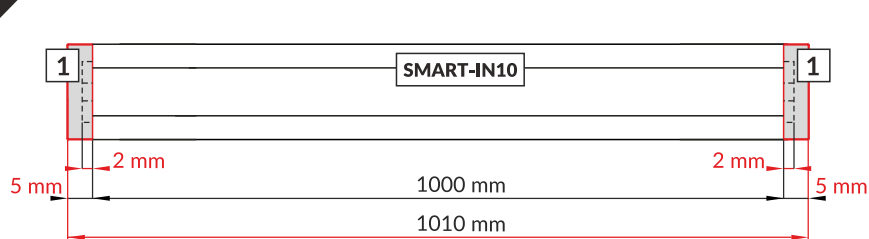

Note! Ending thickness increases the length of the luminaire (+ 2 x 5 mm) and the length of the mounting space (+ 2 x 2 mm).
Uwaga! Grubość zaślepki zwiększa długość oprawy (+ 2 x 5 mm) i długość otworu montażowego (+ 2 x 2 mm).

II

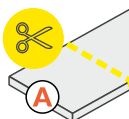

The length of the cover is equal to the length of the profile.
Długość klosza równa jest długości profilu.

III

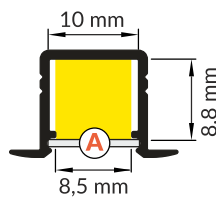
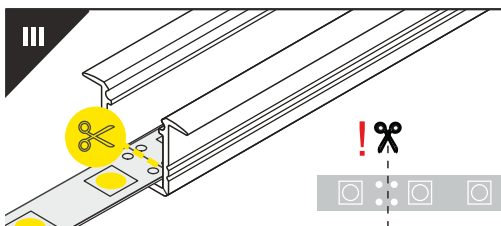

Dimensions of the space to install LED source.
Wymiary przestrzeni do zamontowania źródła LED.

IV

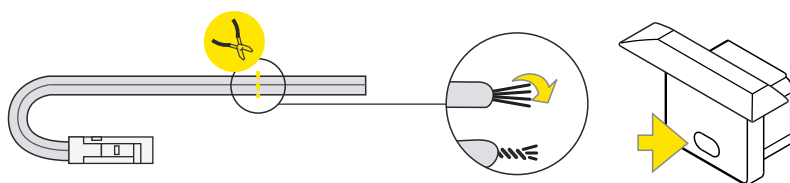
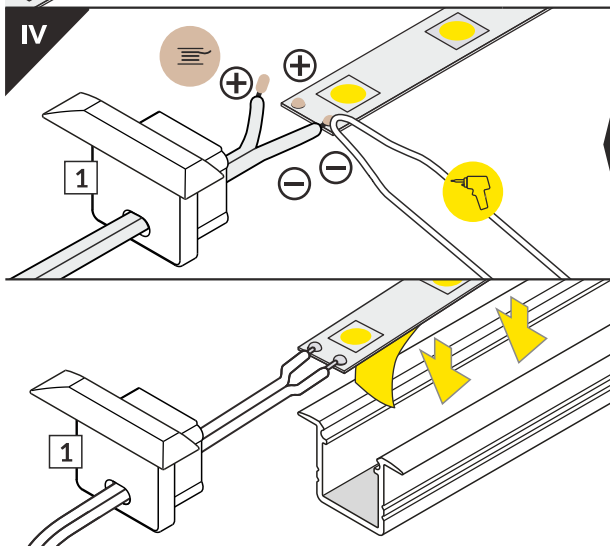

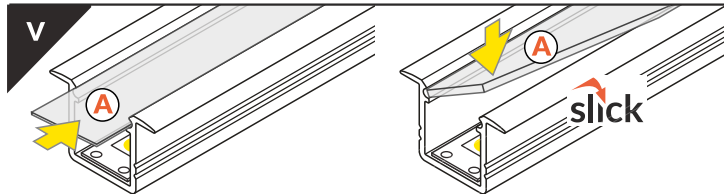

A slide cover / klosz A wsuwany

VI MOUNTING / MONTAŻ

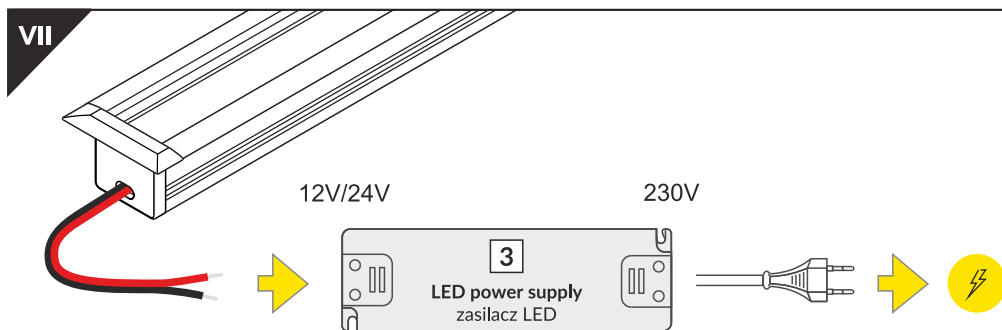
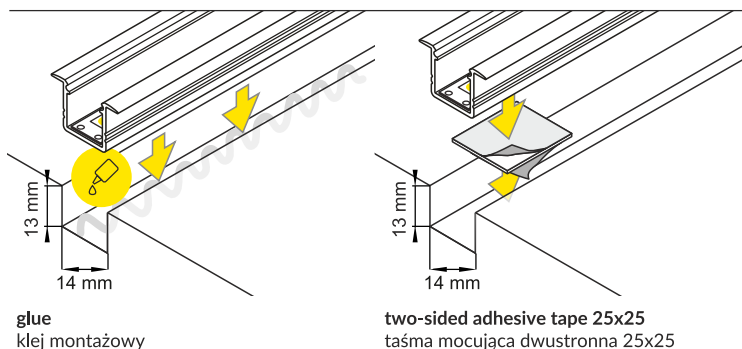
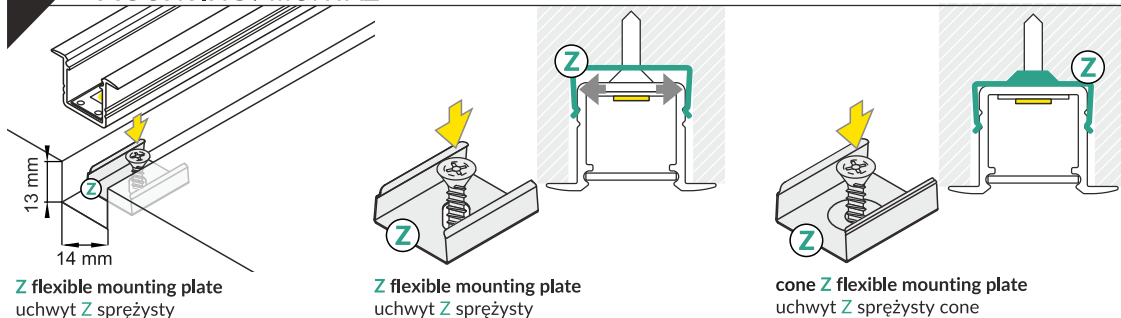

ACCESSORIES / AKCESORIA

- power switches
- controller + remote
- movement sensors
-
- włączniki
- sterownik + pilot
- czujniki ruchu

Check the rest - TOPMET catalogue or www.topmet.co.uk
Zobacz więcej - katalog TOPMET lub www.topmet.pl