

BACK10 A/UX

SPECIAL APPLICATION PROFILE / PROFIL SPECJALNY

max 10 mm

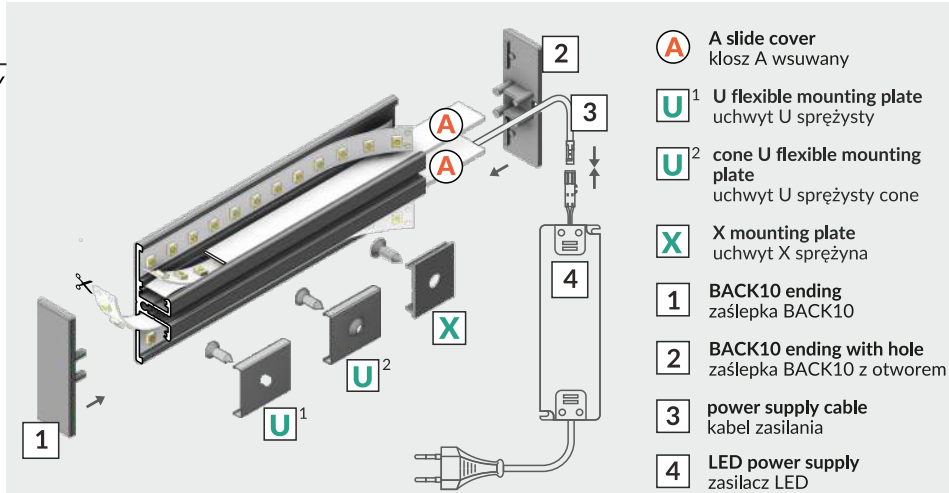
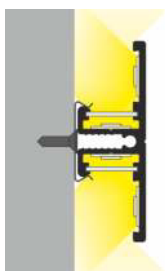
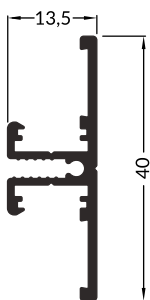

- A** A slide cover
klosz A wsuwany
- U¹** U flexible mounting plate
uchwyt U sprężysty
- U²** cone U flexible mounting
uchwyt U sprężysty cone
- X** X mounting plate
uchwyt X sprężyna
- 1** BACK10 ending
zaślepka BACK10
- 2** BACK10 ending with hole
zaślepka BACK10 z otworem
- 3** power supply cable
kabel zasilania
- 4** LED power supply
zasilacz LED

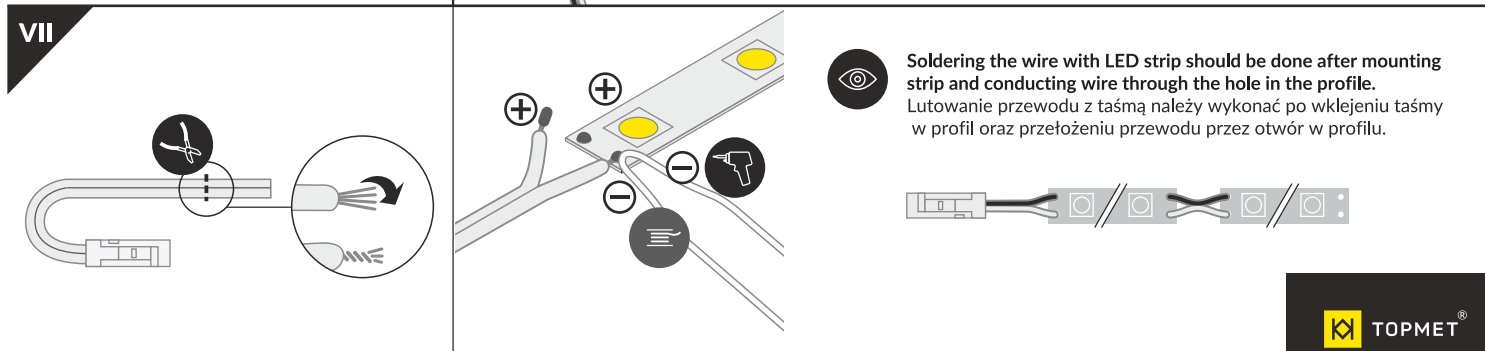
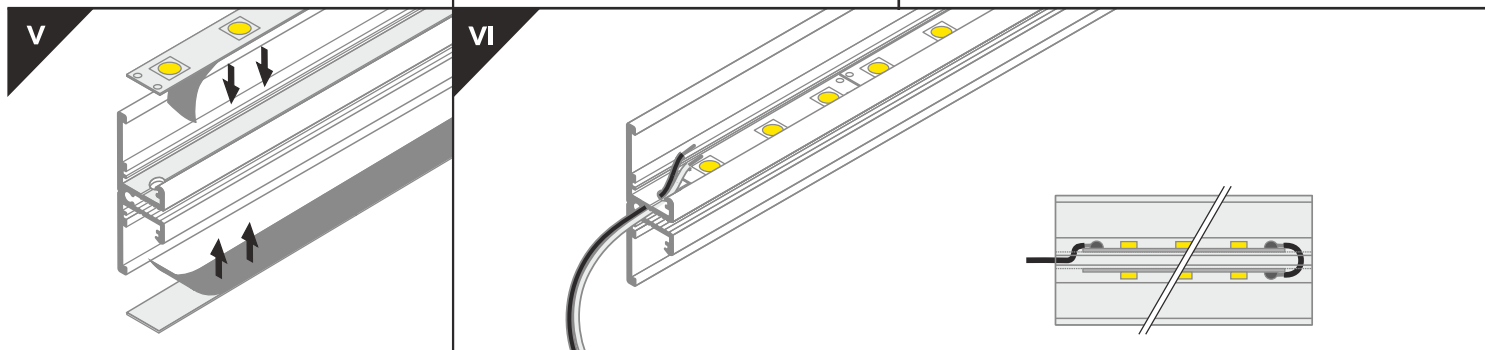
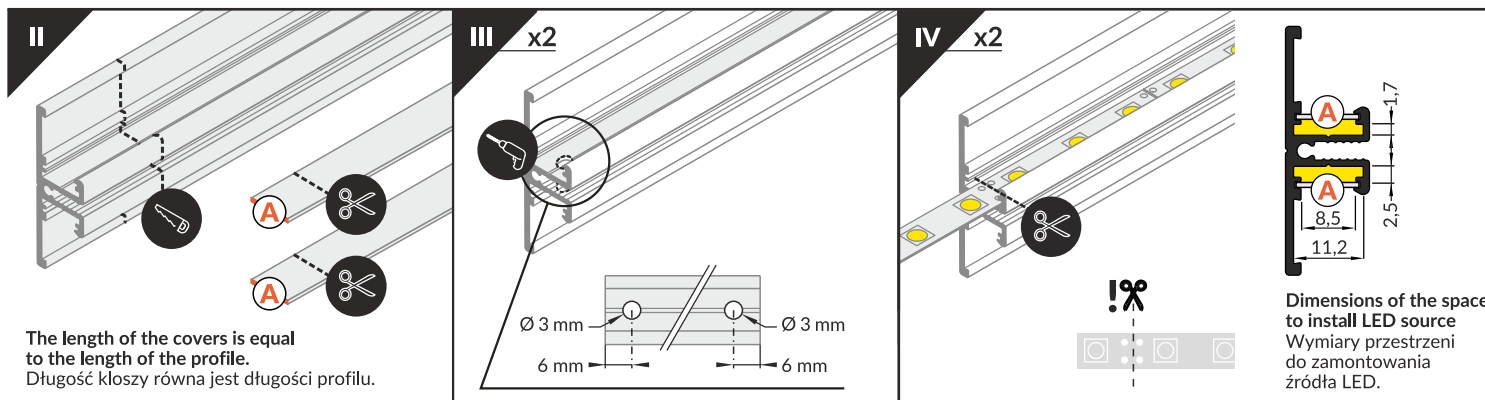
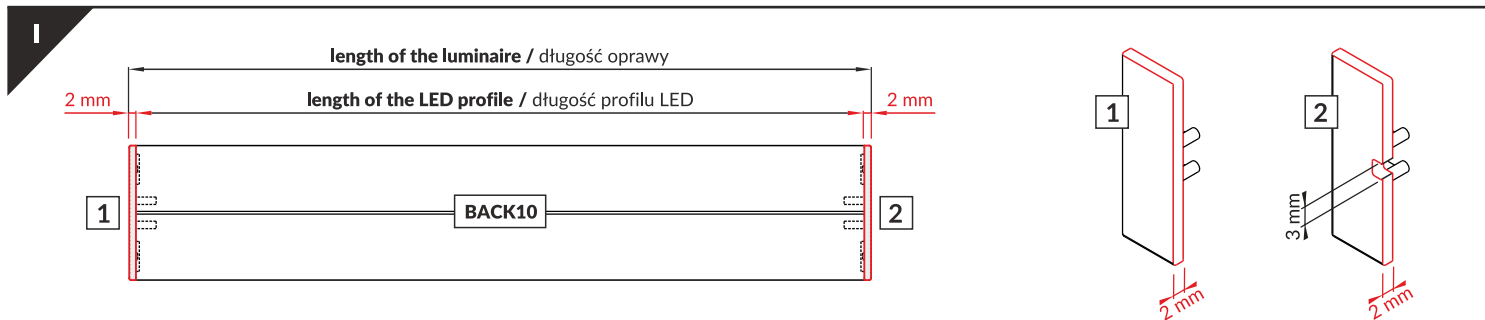
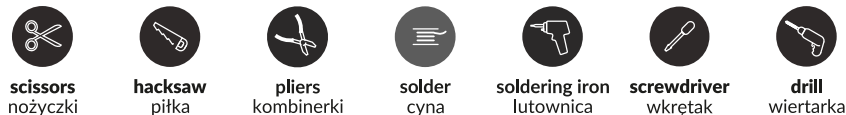

VIII

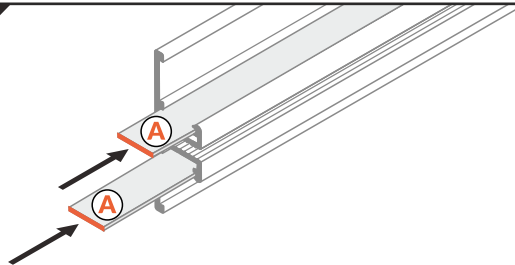

IX

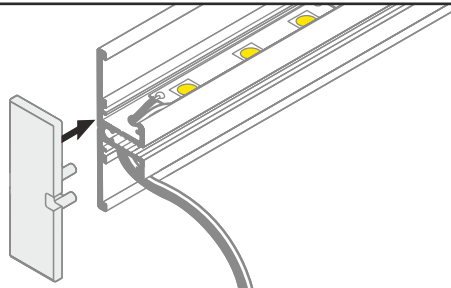

X

MOUNTING / MONTAŻ

Mounting plates / Uchwyty

U flexible mounting plate
uchwyt U sprężysty

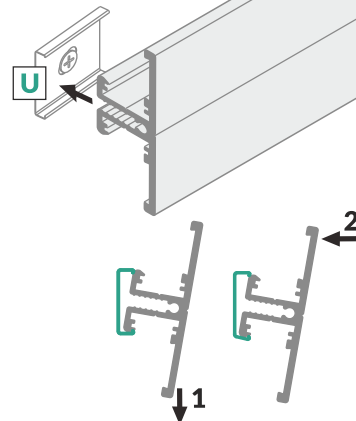
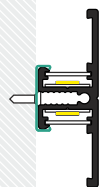

cone U flexible mounting plate
uchwyt U sprężysty cone

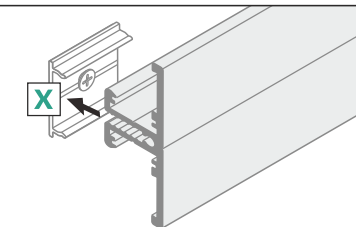
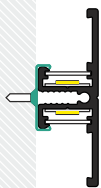

X mounting plate
uchwyt X

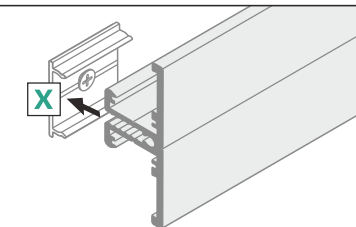

Screws / Wkręty

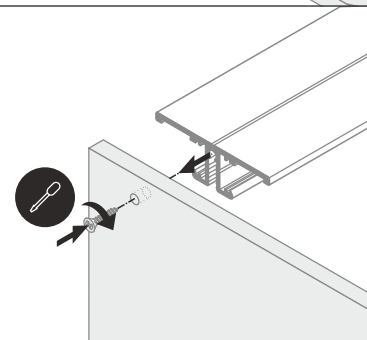
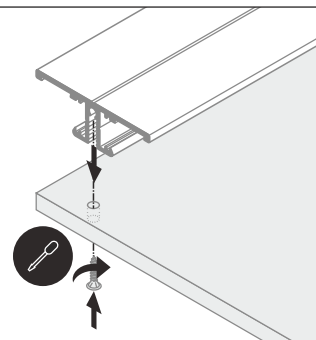

XI

POWER SUPPLY / ZASILANIE

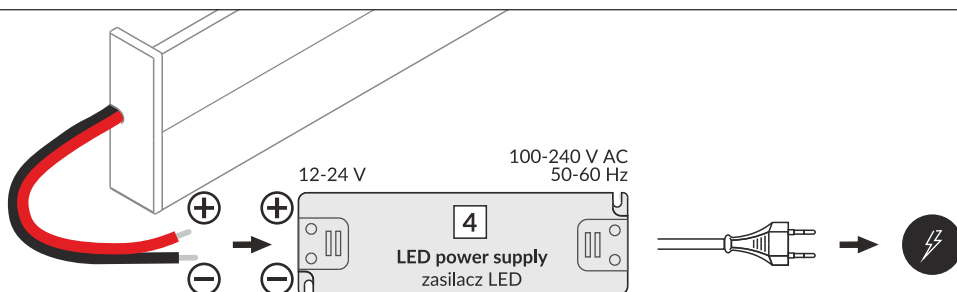

OPTIONAL ACCESSORIES / AKCESORIA OPCJONALNE



Mount the connector before installing the LED strip. In case there is no possibility of sliding the profile into connector it is recommended to mount with screws, directly to the mounting surface / łącznik montować przed instalacją taśmy LED. W przypadku braku możliwości wsunięcia profilu w element łączący zalecany jest montaż na wkręty, bezpośrednio do powierzchni montażowej

X connector 180 deg
łącznik X 180 st

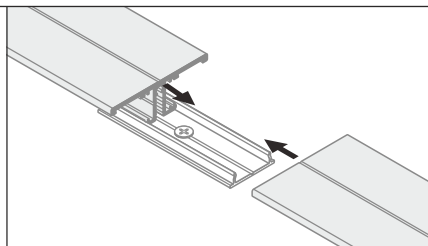
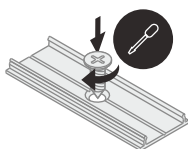

X connector may be used to make extra long profiles by connecting multiple profiles. łącznik X może być użyty do stworzenia pojedynczego bardzo długiego profilu.



ACCESSORIES / AKCESORIA

power switches / włączniki
controller + remote / sterownik + pilot
movement sensors / czujniki ruchu

TOPMET Light Kłósowicz Wiśniewski i Wspólnik Sp.J.

Ostrowska 354 | 61-312 Poznań | POLAND
tel.: +48 61 872 75 00
www.topmet.pl/en

07.2020

TOPMET®