

# PEN8 I

SURFACE PROFILE / NAWIERZCHNIOWY

TOPMET®

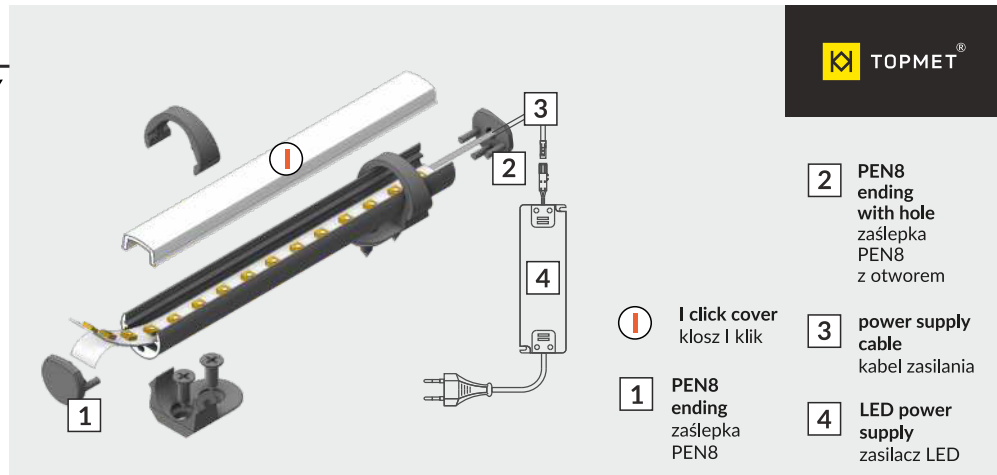
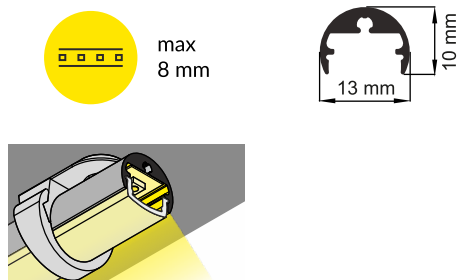

scissors  
nożyczki



pliers  
kombinerki



hacksaw  
piła



soldering iron  
lutownica



solder  
cyna



drill  
wiertarka

I

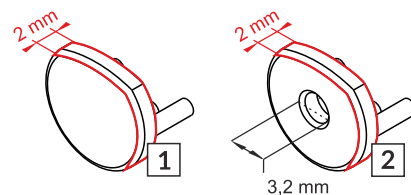
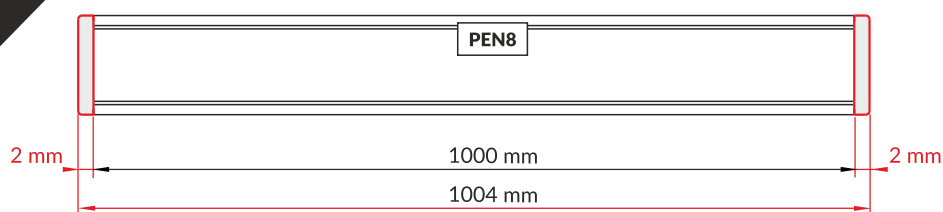

**Note!** Ending thickness increases the length of the luminaires (+ 2 x 2 mm).

**Uwaga!** Grubość zaślepki zwiększa długość oprawy (+ 2 x 2 mm).

II

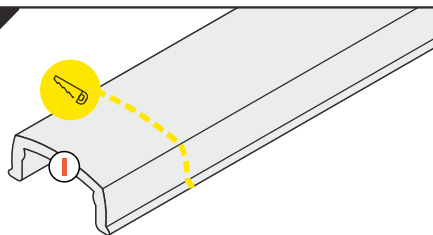

The length of the cover is equal to the length of the profile.

Długość klosza równa jest długości profilu.

III

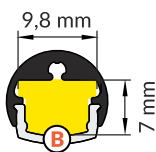
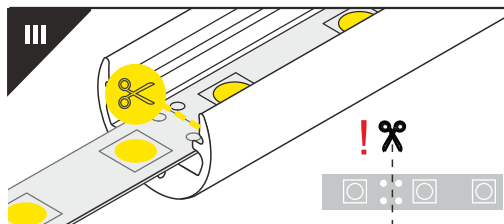

Dimensions of the space to install LED source  
Wymiary przestrzeni do zamontowania źródła LED.

IV

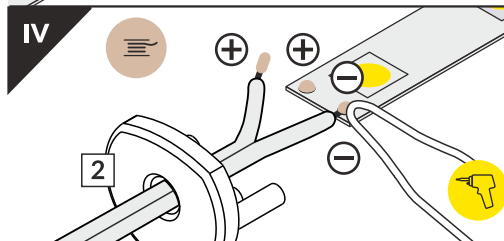

V

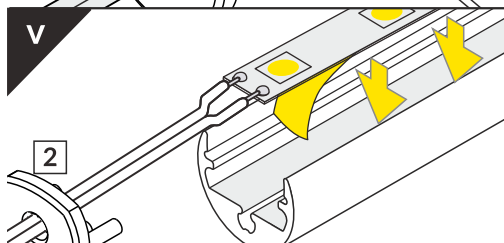

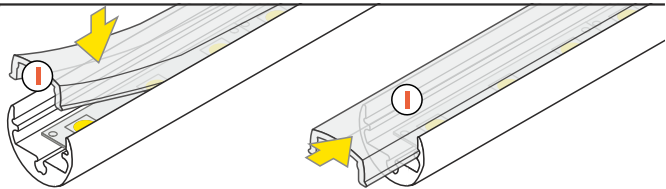

I slide cover / klosz I klik

## VII MOUNTING / MONTAŻ

page / str. 2	PEN8 simple holder / uchwyt PEN8 prosty
page / str. 2	PEN8 ring holder / uchwyt PEN8 ring
page / str. 3	PEN8 holder flat / uchwyt PEN8 płaski
page / str. 3	PEN8 stretcher holder / uchwyt PEN8 rozporowy
page / str. 4	PEN8 jointed holder with thread / uchwyt PEN8 przegubowy z gwintem
page / str. 5	PEN8 jointed holder with ceiling / uchwyt PEN8 przegubowy z podsufitką
page / str. 6	PEN8 double holder with threads / uchwyt PEN8 podwójny z gwintem
page / str. 7	PEN8 double holder with ceilings / uchwyt PEN8 podwójny z podsufitką
page / str. 8	PEN8 end holder / uchwyt PEN8 końcowy

### PEN8 simple holder / uchwyt PEN8 prosty

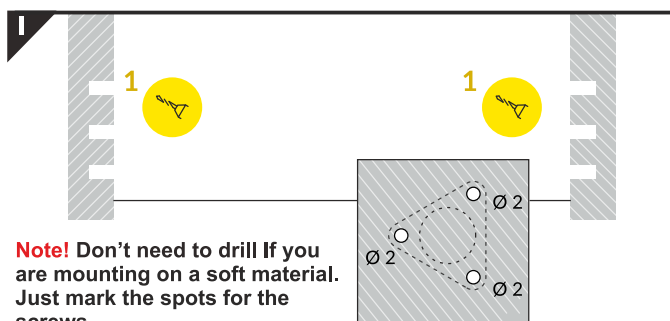

**Note! Don't need to drill if you are mounting on a soft material. Just mark the spots for the screws.**

**Uwaga!** Jeżeli montujesz w miękkim materiale, możesz jedynie zaznaczyć punkty na śruby.

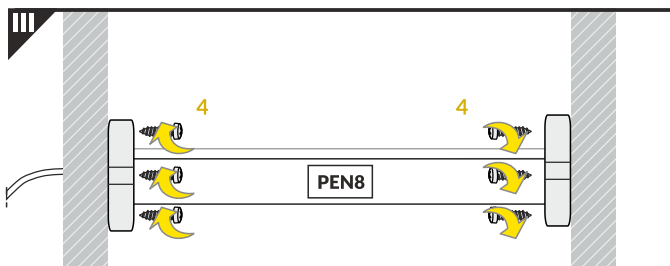
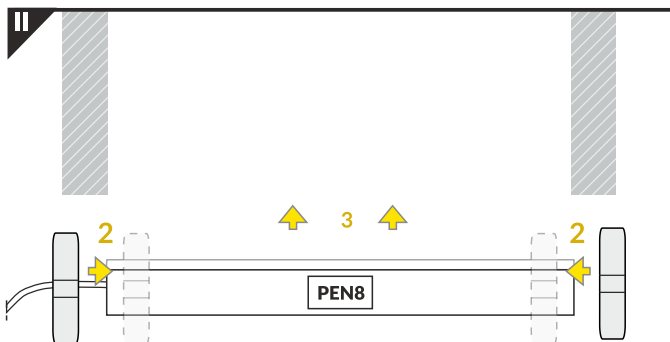

### PEN8 ring holder / uchwyt PEN8 ring

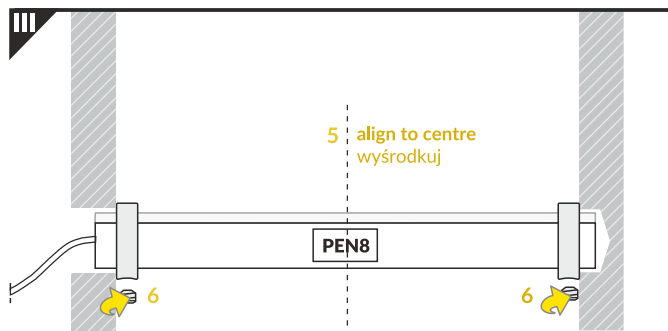
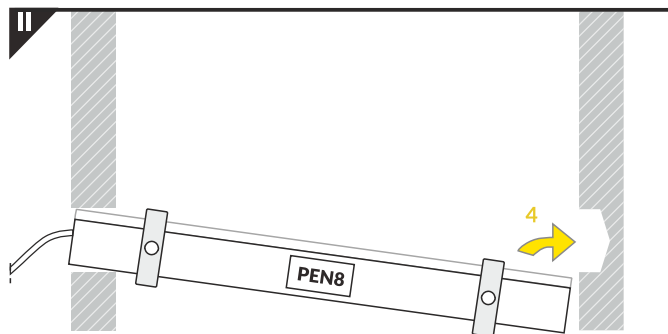
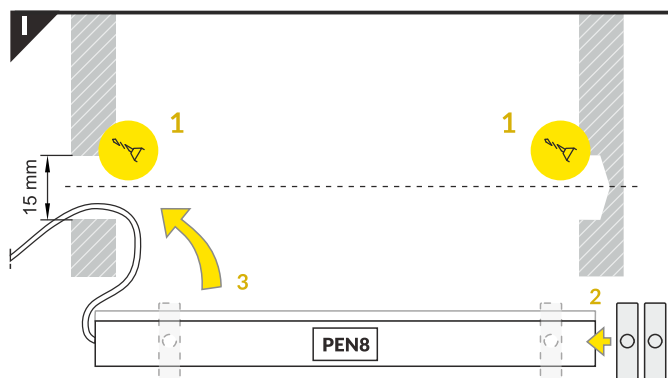

## PEN8 holder flat / uchwyt PEN8 płaski

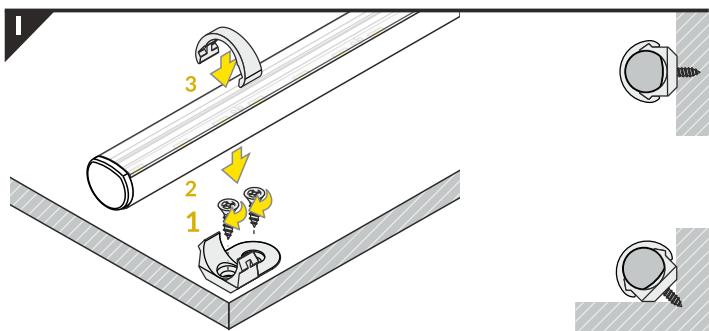

## PEN8 stretcher holder / uchwyt PEN8 rozporowy

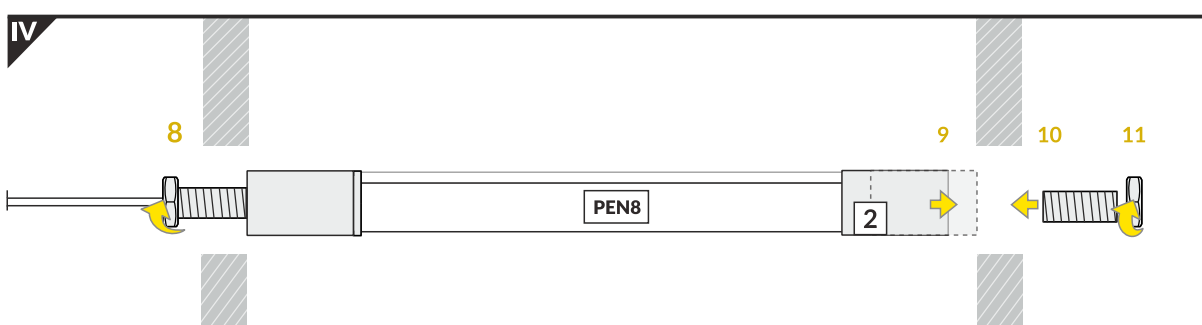
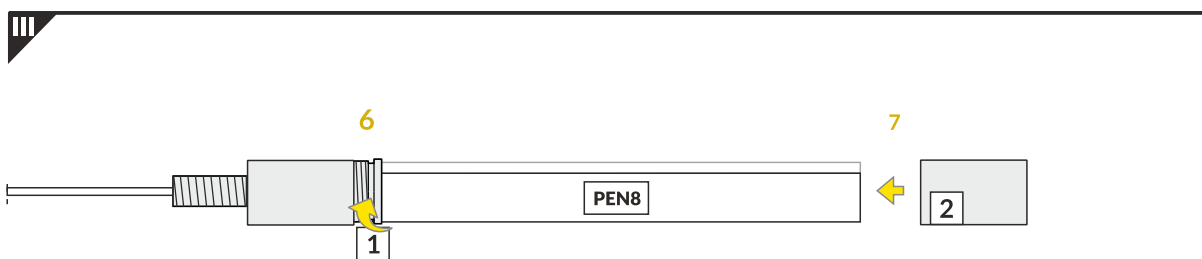
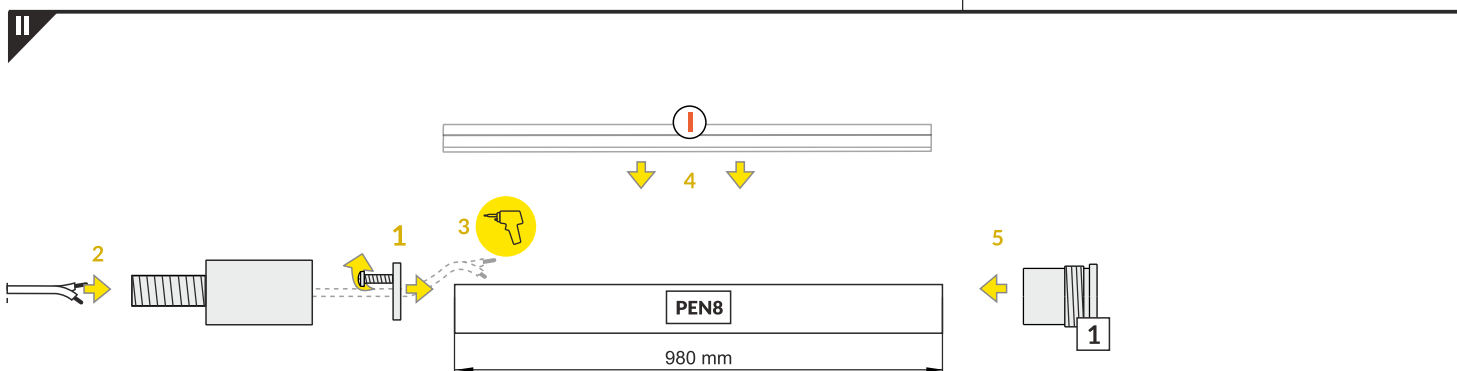
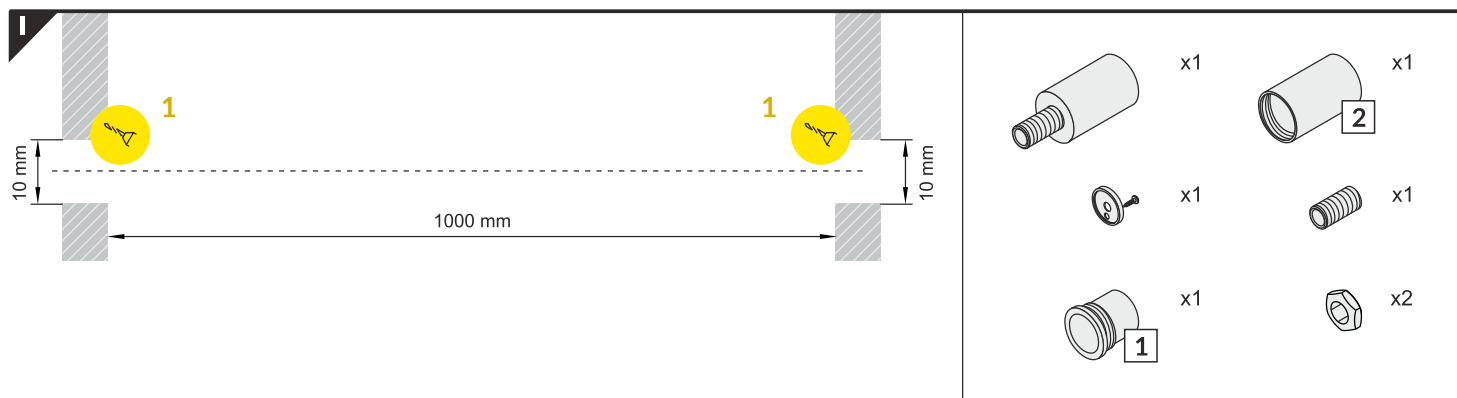

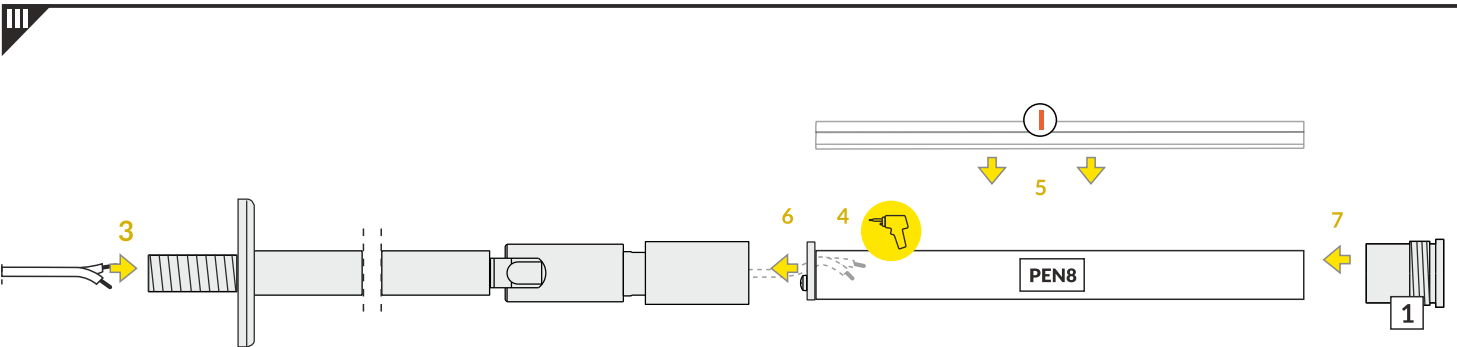

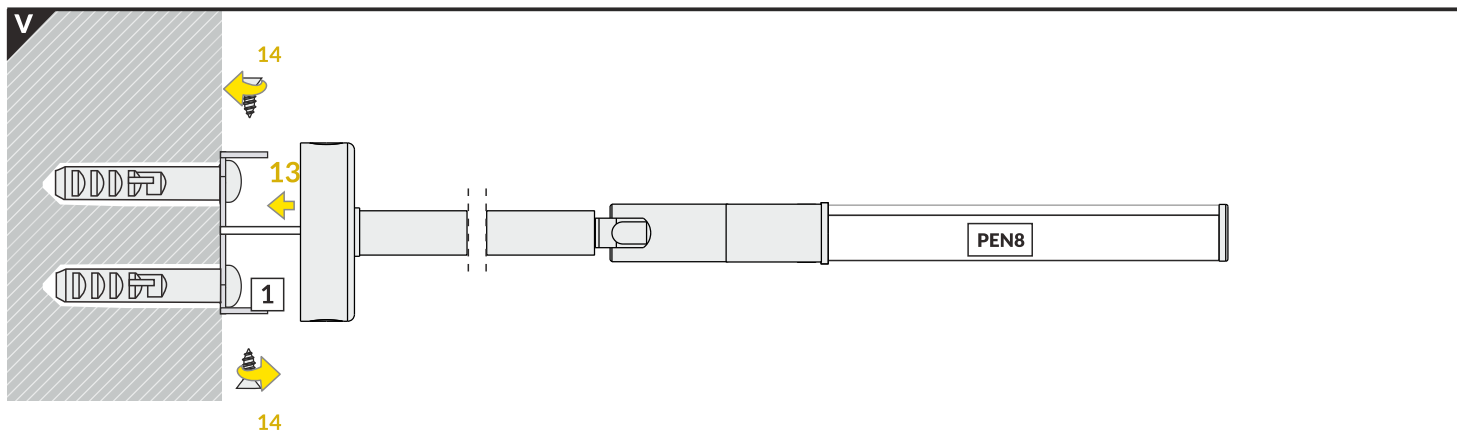
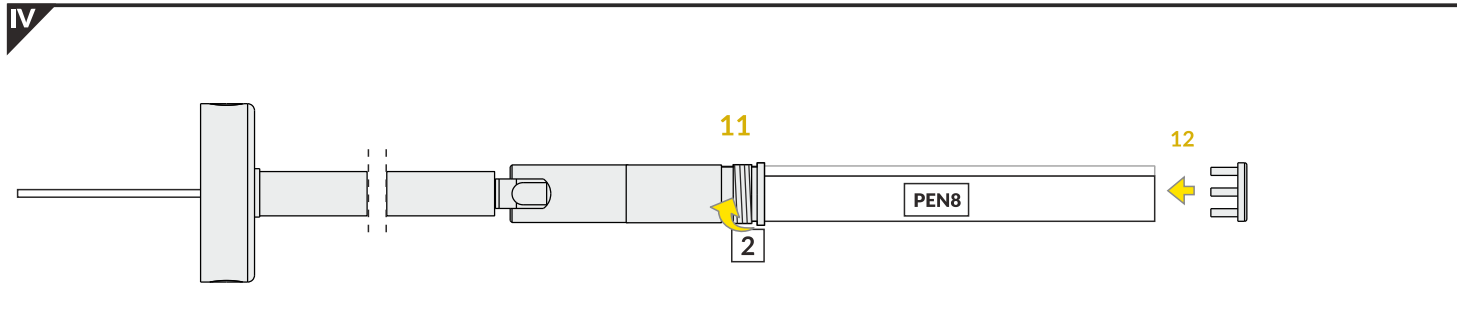
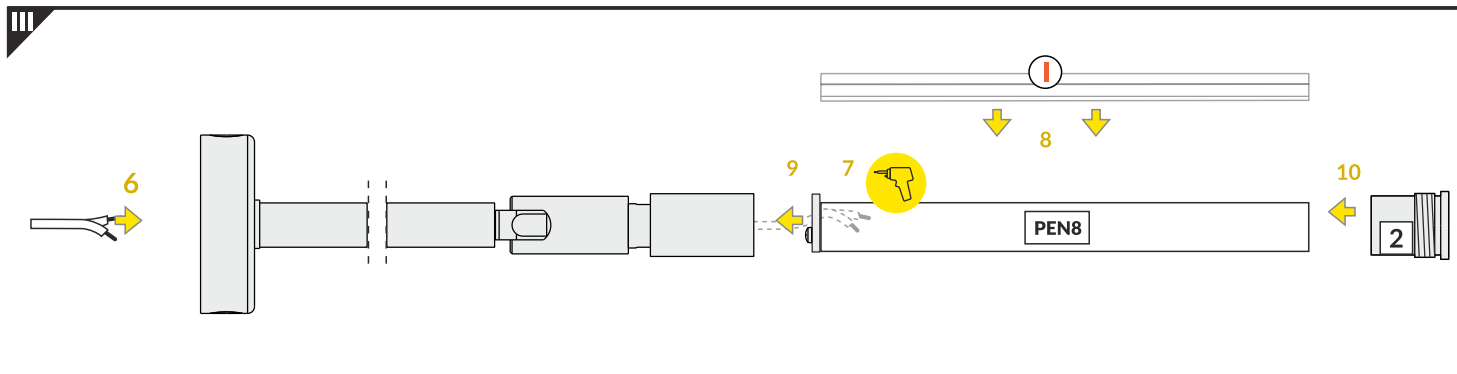
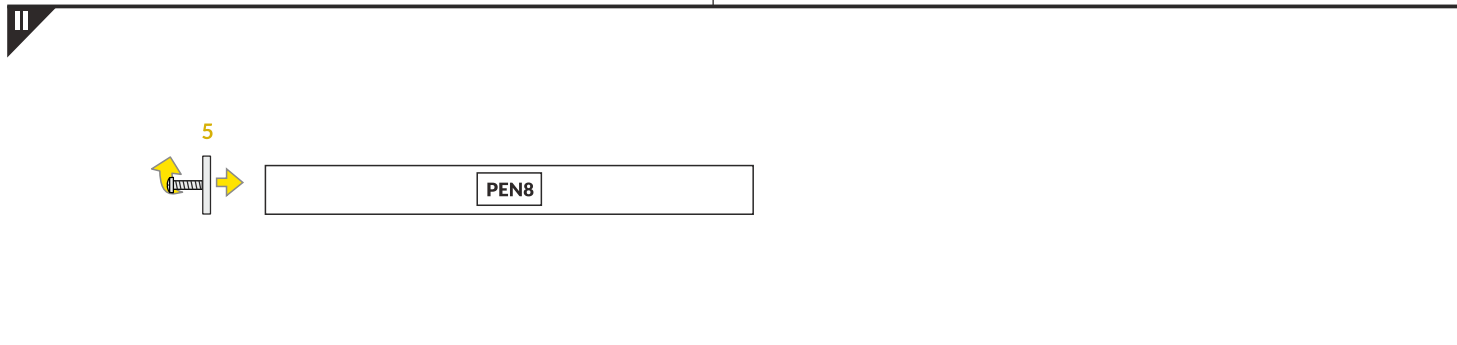
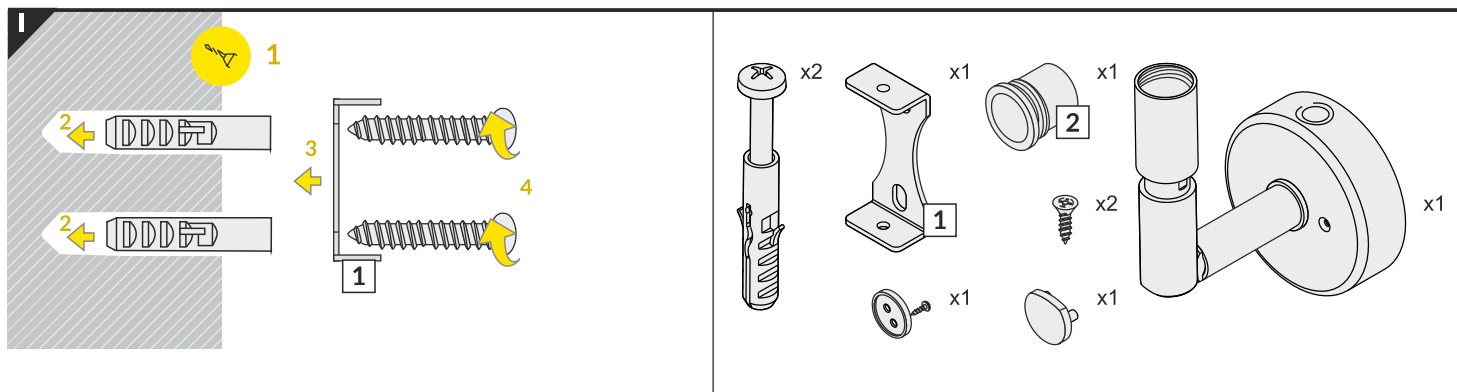

PEN8 double holder with threads / uchwyt PEN8 podwójny z gwintem

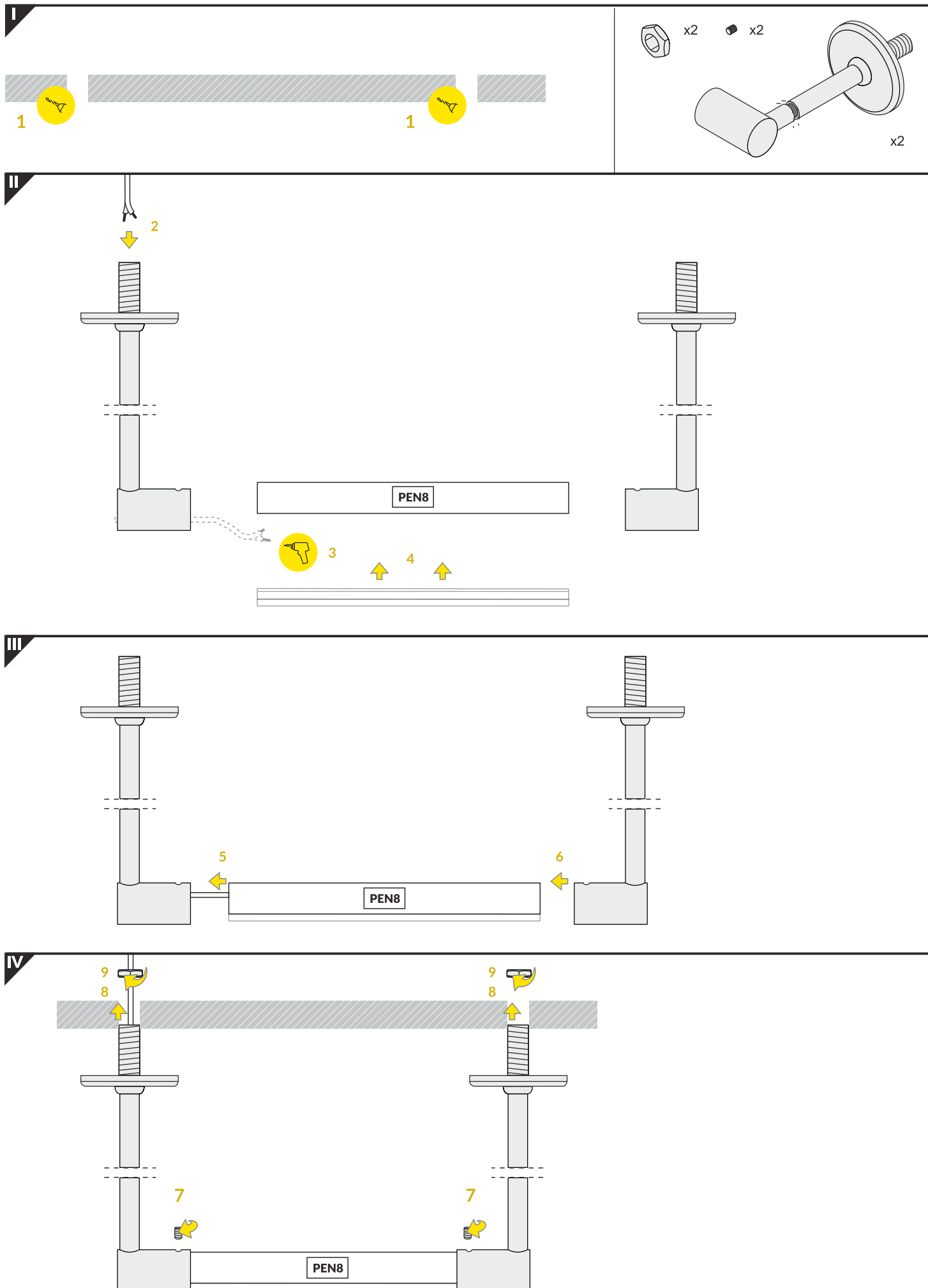

PEN8 double holder with threads / uchwyt PEN8 podwójny z podsufitkami

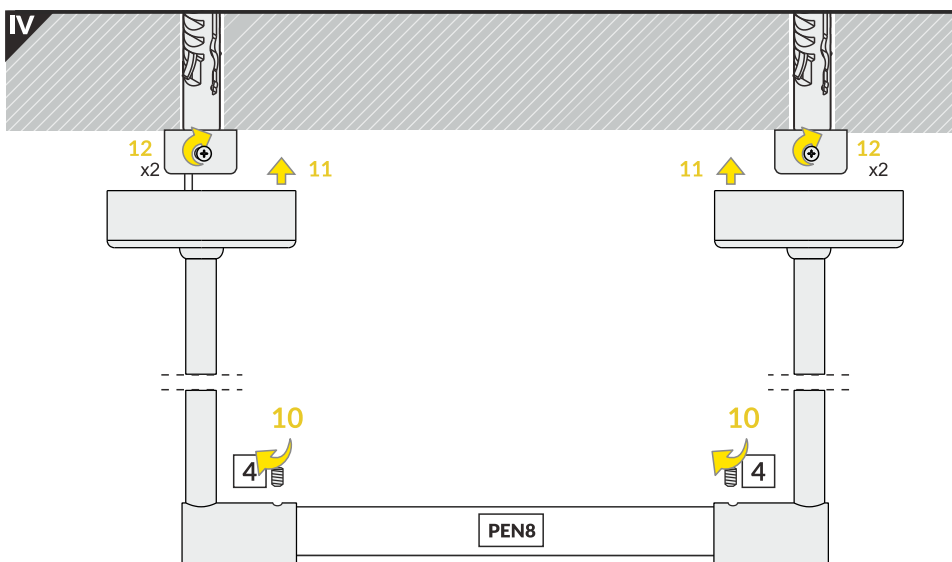
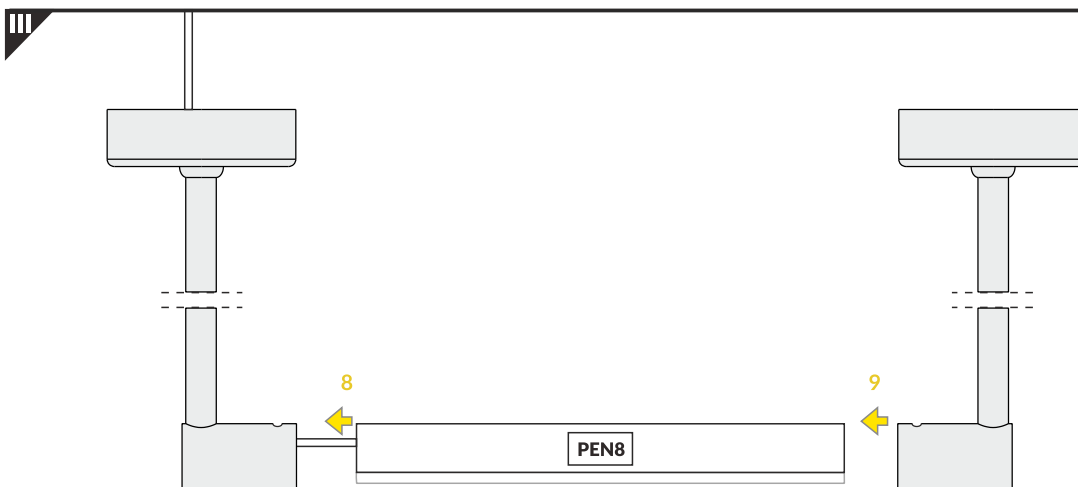
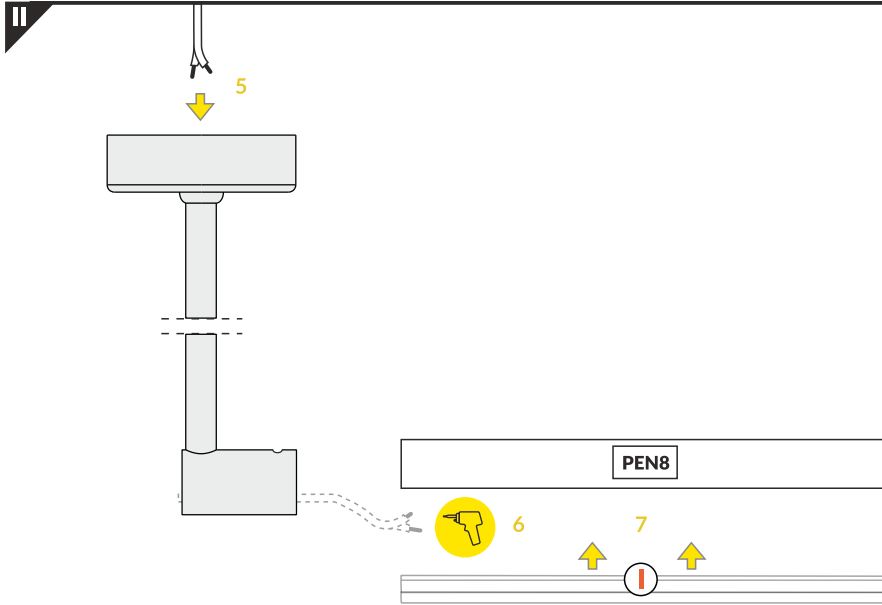
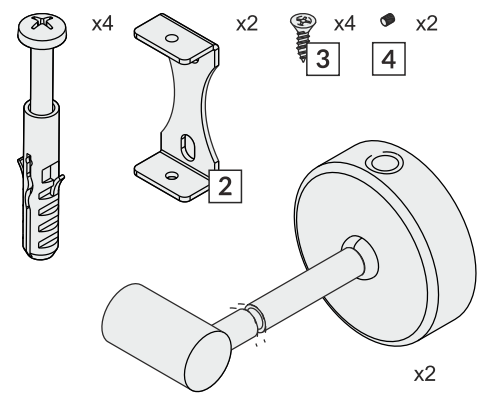
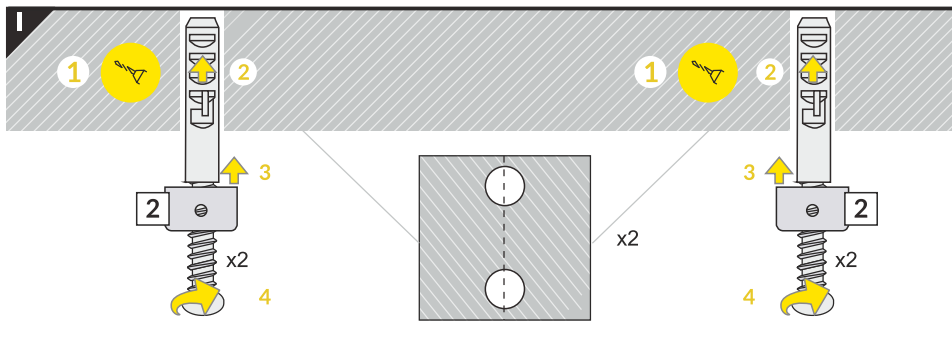

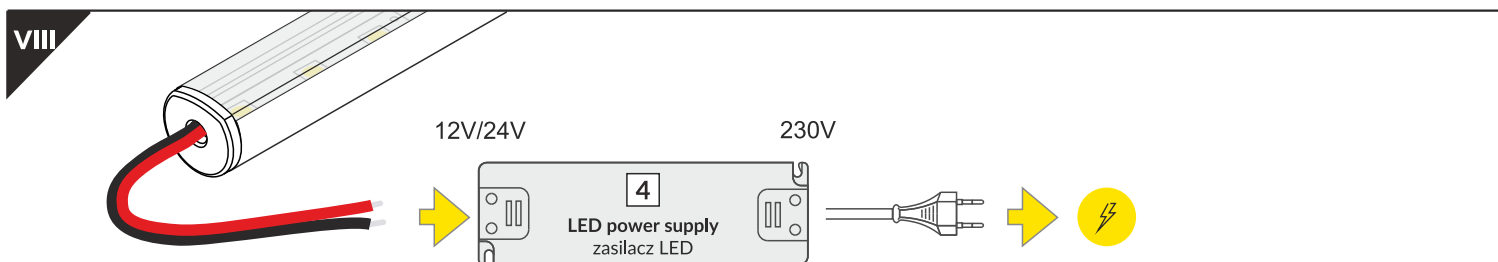
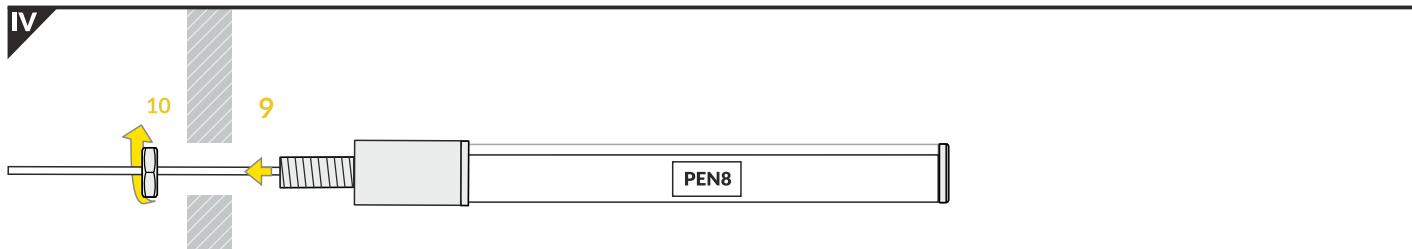
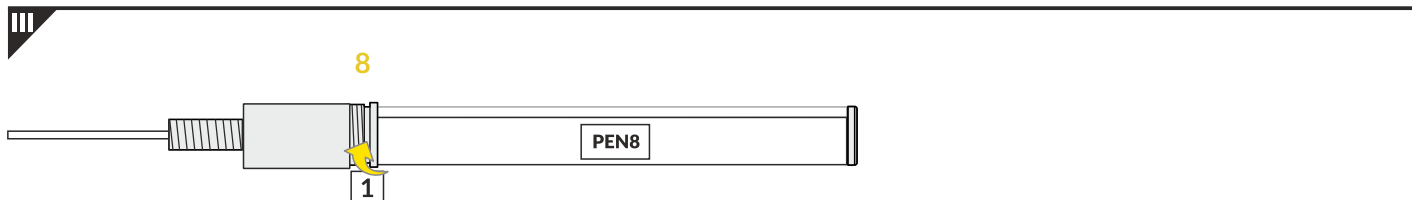
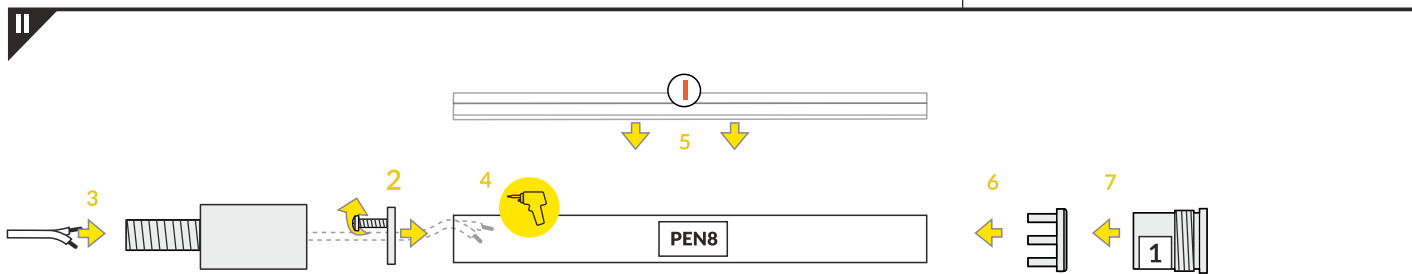

## ACCESSORIES / AKCESORIA

- power switches
- controller + remote
- movement sensors
- włączniki
- sterownik + pilot
- czujniki ruchu

Check the rest - TOPMET catalogue or [www.topmet.co.uk](http://www.topmet.co.uk)  
Zobacz więcej - katalog TOPMET lub [www.topmet.pl](http://www.topmet.pl)