

# SURFACE14 EF/TY

SURFACE PROFILE / PROFIL NAWIERZCHNIOWY

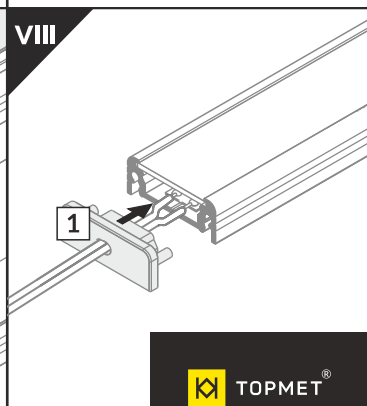
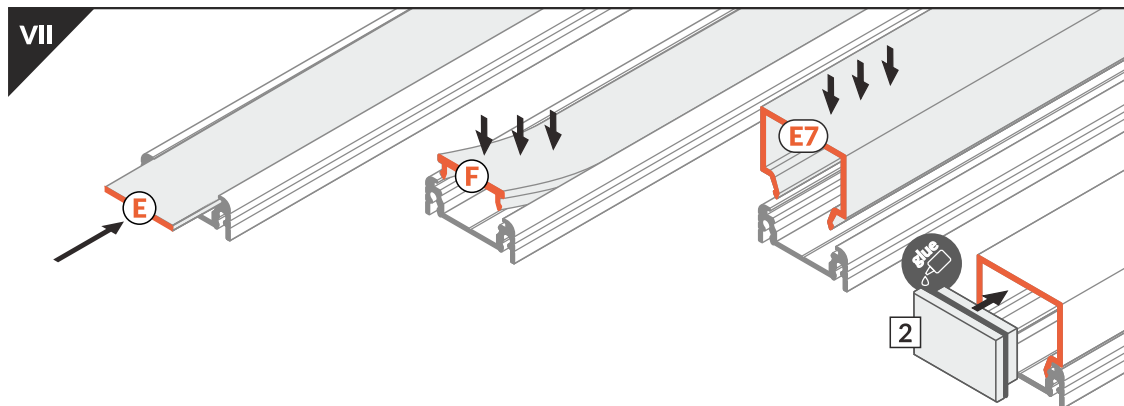
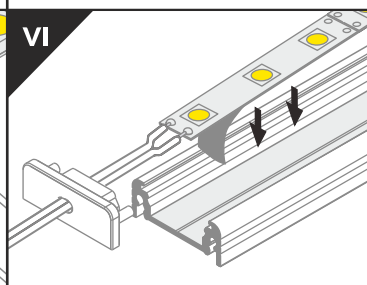
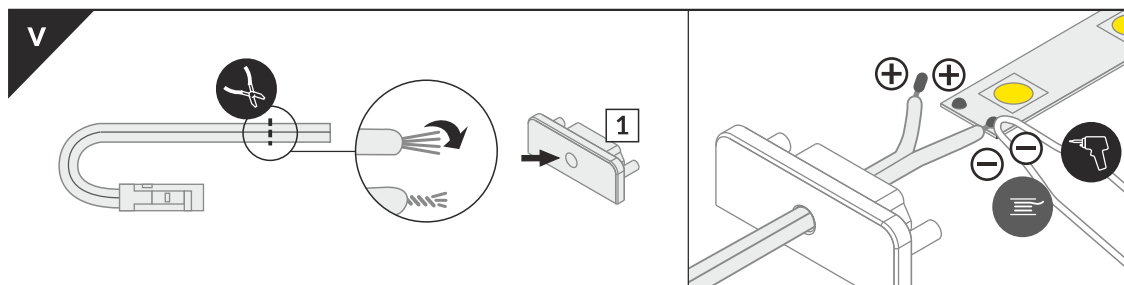
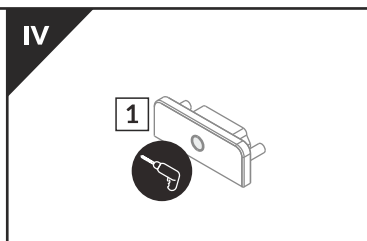
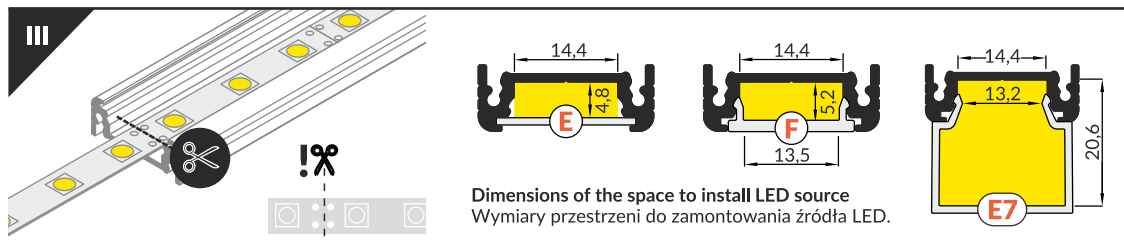
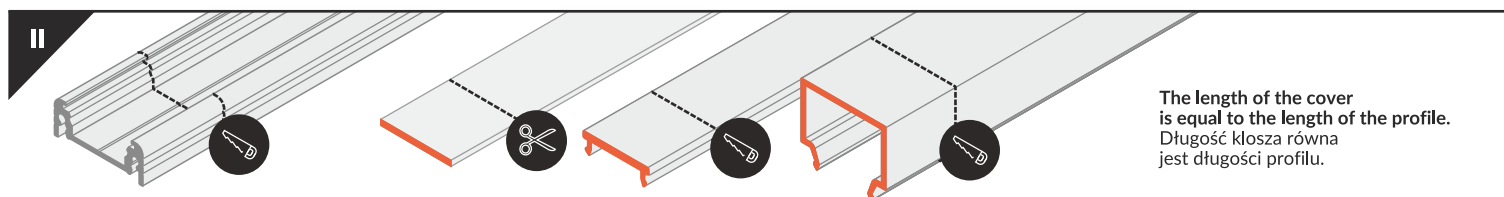
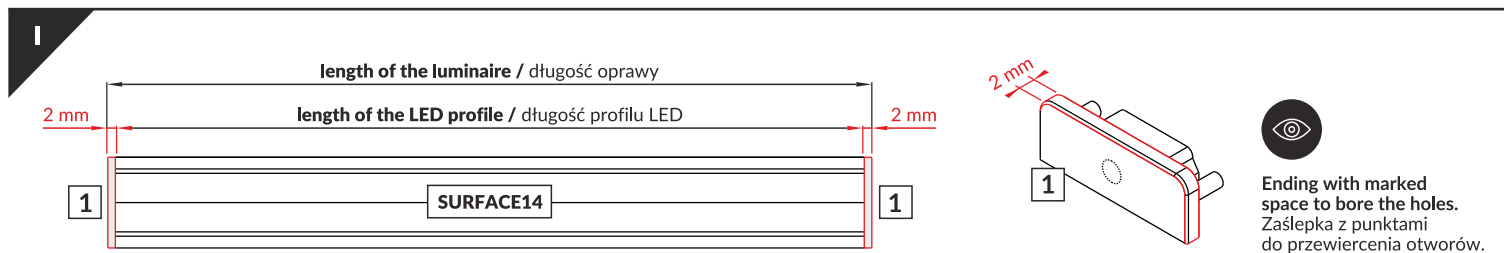
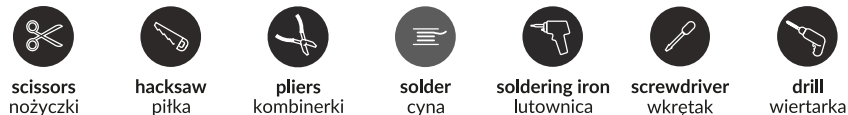
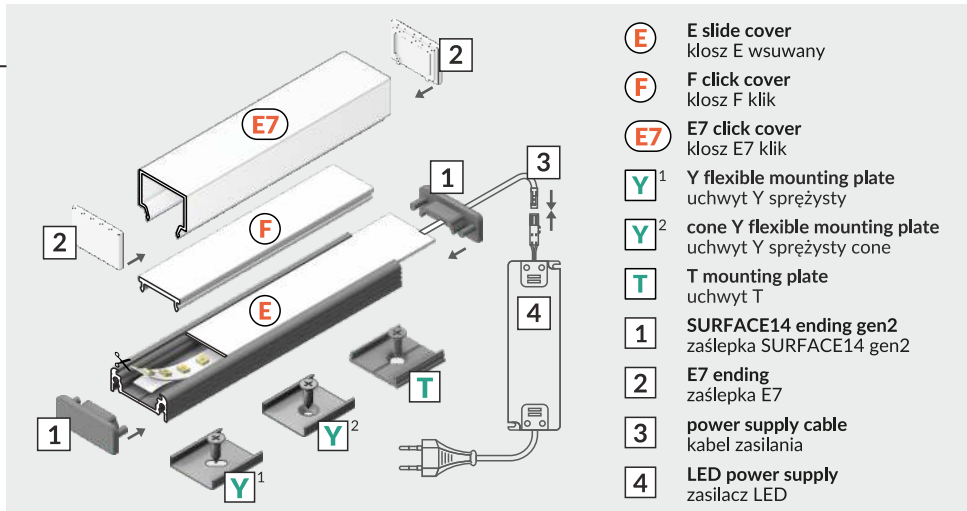
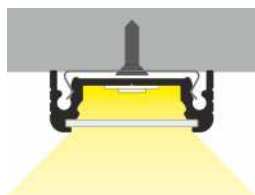
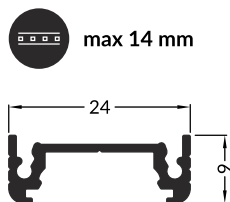

## IX MOUNTING / MONTAŻ

**Y flexible mounting plate**  
uchwyt Y sprężysty

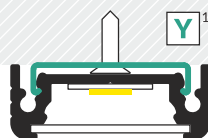

**cone Y flexible mounting plate**  
uchwyt Y sprężysty cone

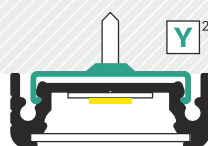

**T mounting plate**  
uchwyt T

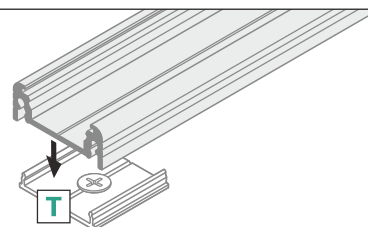
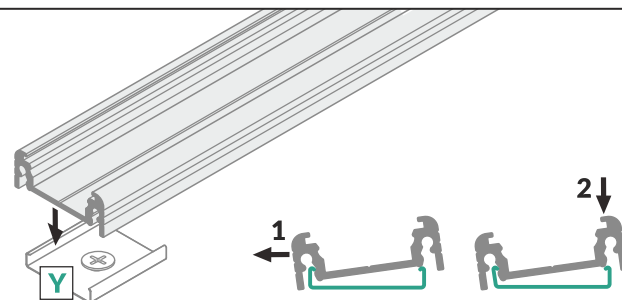
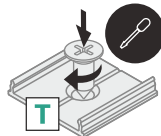
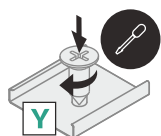
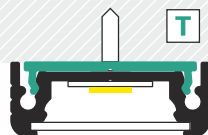

Other mounting possibilities: with mounting glue or mounting tape, with screws  
Pozostałe możliwości montażu: na klej lub taśmę montażową, na wkręty

## X POWER SUPPLY / ZASILANIE

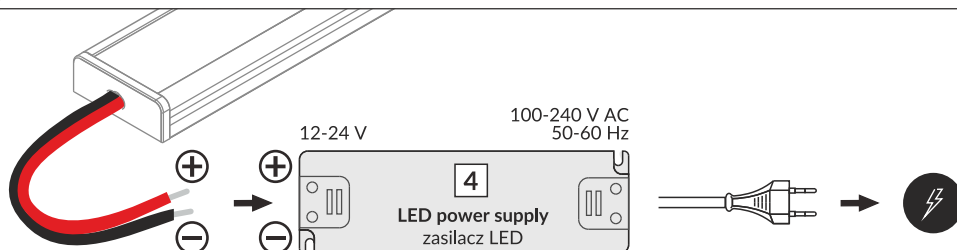

## OPTIONAL ACCESSORIES / AKCESORIA OPCJONALNE



Mount the connector before installing the LED strip. In case there is no possibility of sliding the profile into connector it is recommended to mount with screws, directly to the mounting surface / Łącznik montować przed instalacją taśmy LED. W przypadku braku możliwości wsunięcia profilu w element łączący zalecany jest montaż na wkręty, bezpośrednio do powierzchni montażowej

**T connector 180 deg**  
łącznik T 180 st

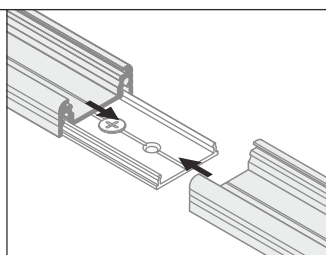
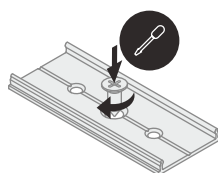

T connector may be used to make extra long profiles by connecting multiple profiles.  
Łącznik T może być użyty do stworzenia pojedynczego bardzo długiego profilu.



**SURFACE14 connector 90 deg**  
łącznik SURFACE14 90 st

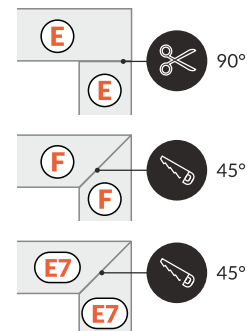
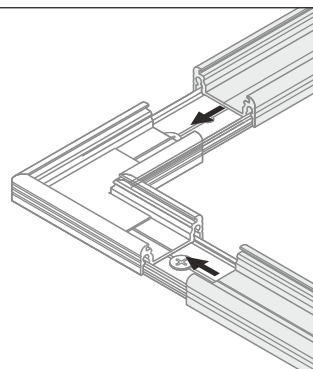
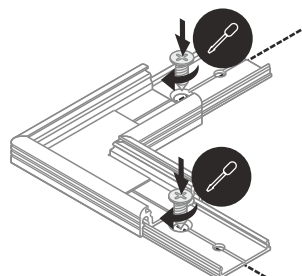
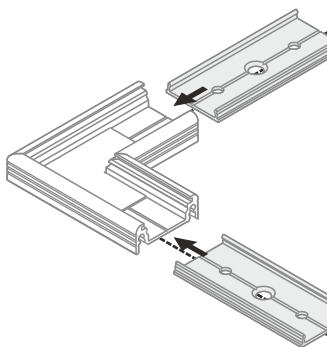

## ACCESSORIES / AKCESORIA

power switches / włączniki  
controller + remote / sterownik + pilot  
movement sensors / czujniki ruchu

TOPMET Light Kłosowicz Wiśniewski i Wspólnik Sp.J.

Ostrowska 354 | 61-312 Poznań | POLAND  
tel.: +48 61 872 75 00  
www.topmet.pl/en

07.2020

**TOPMET®**